

Attachment B – Santa Clara County Urban Island Maps

Urban islands for each city in Santa Clara County are shown on the following pages.



SANTA CLARA COUNTY Urban Islands 2015

Maps depicting unincorporated lands located within the cities' Urban Service Areas (USAs)

Cupertino: Page 1 of 4

This map created by the Santa Clara County Planning Office. The GIS data was compiled from various sources. While deemed reliable, the Planning Office assumes no liability.
3/11/2015 9:56:03 AM V:\Projects\Urban Islands\Urban Islands 2015\Urban Islands 2015_master.mxd

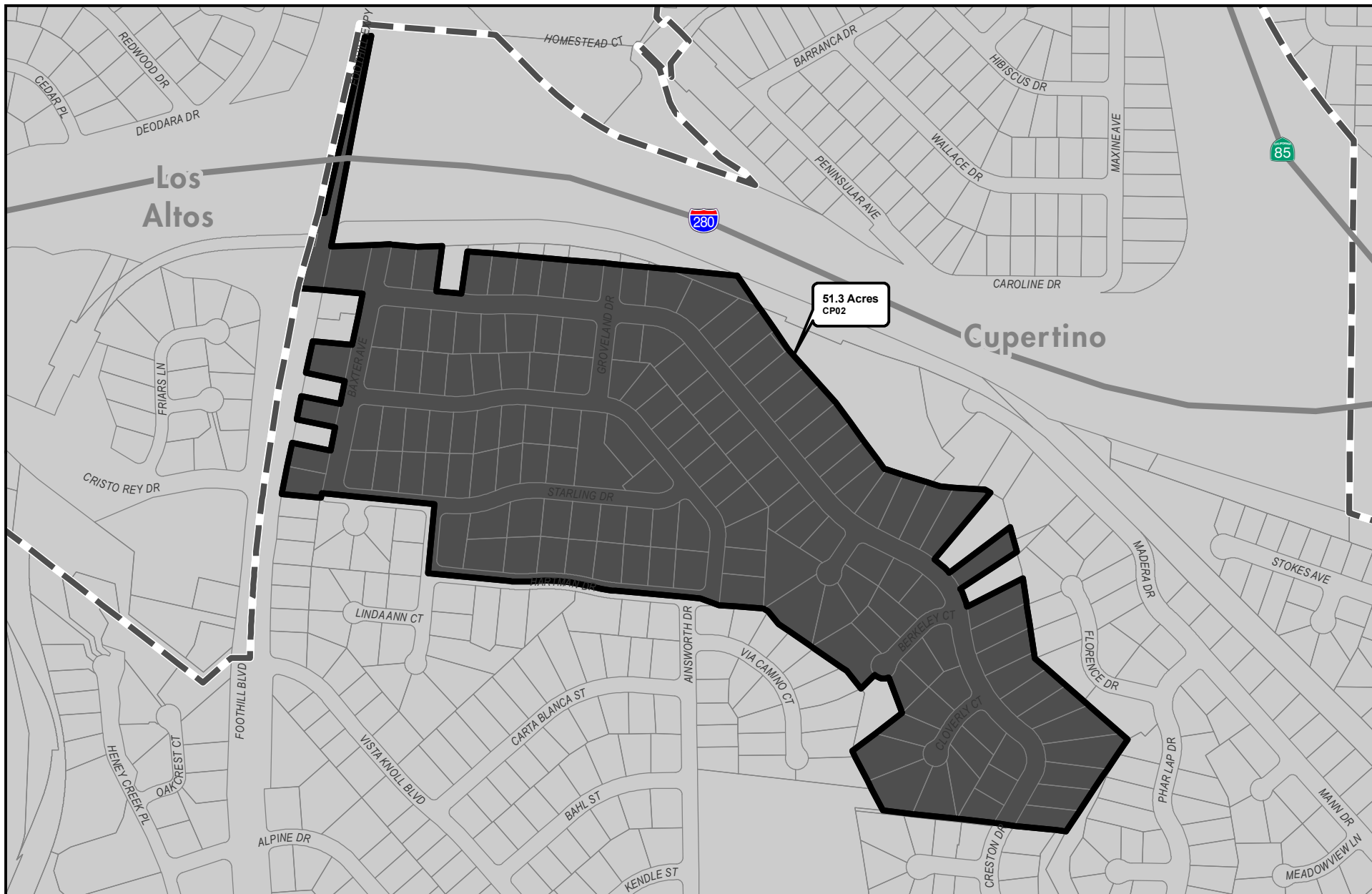

51.3 Acres
CP02

SANTA CLARA COUNTY Urban Islands 2015

Maps depicting unincorporated lands located within the cities' Urban Service Areas (USAs)

Cupertino: Page 2 of 4



Incorporated Areas



Urban Service Area



Urban Island ≤ 150 Acres



Urban Island > 150 Acres

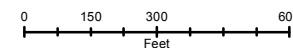

This map created by the Santa Clara County Planning Office. The GIS data was compiled from various sources. While deemed reliable, the Planning Office assumes no liability.

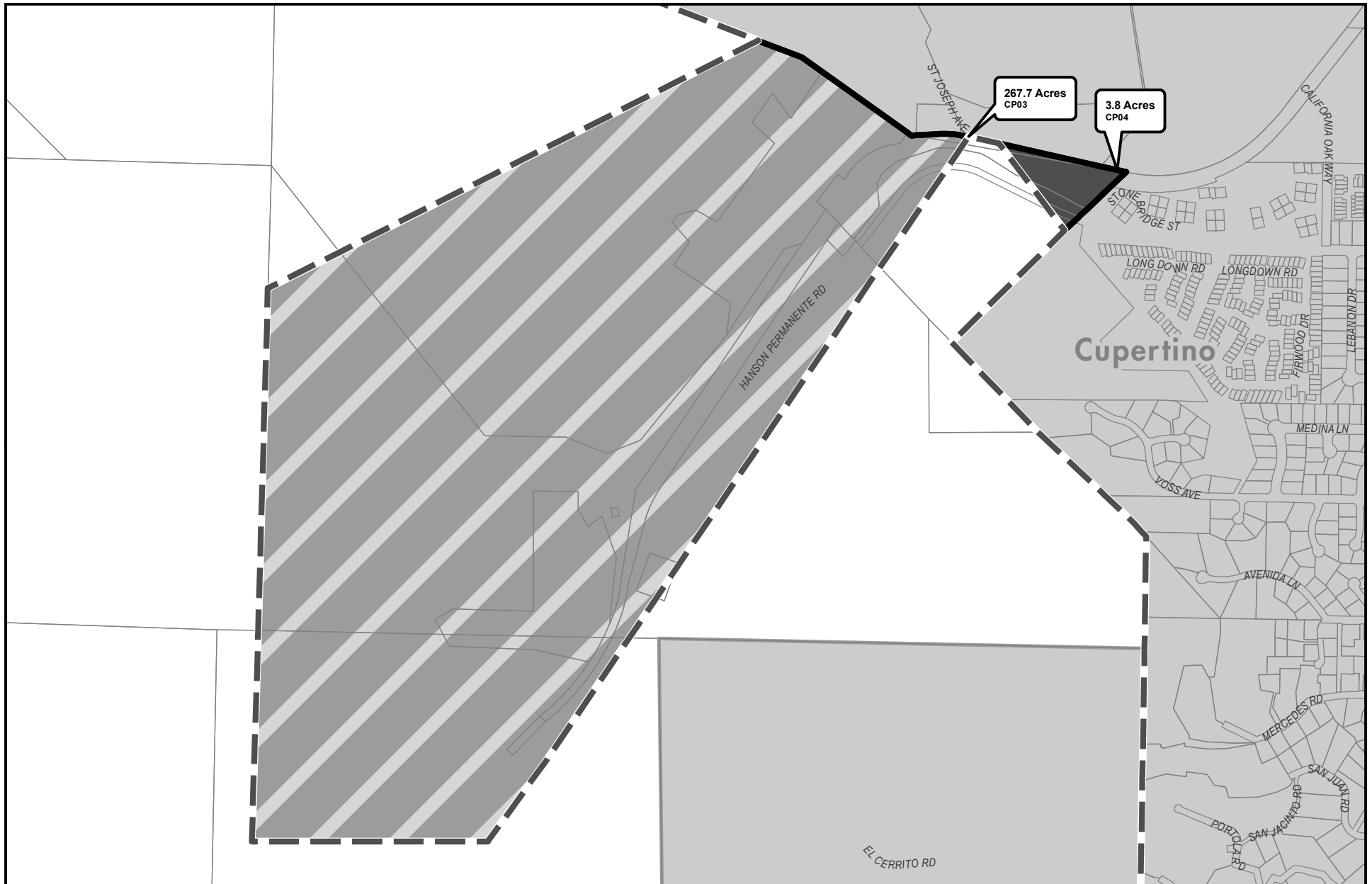

SANTA CLARA COUNTY Urban Islands 2015

Maps depicting unincorporated lands located within the cities' Urban Service Areas (USAs)

Cupertino: Page 3 of 4

 Incorporated Areas

 Urban Service Area

 Urban Island \leq 150 Acres

 Urban Island $>$ 150 Acres

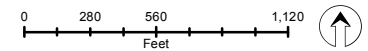

This map created by the Santa Clara County Planning Office. The GIS data was compiled from various sources. While deemed reliable, the Planning Office assumes no liability.
3/11/2015 9:56:03 AM Y:\Projects\Urban Islands\Urban Islands 2015\UrbanIslands2015_master.mxd

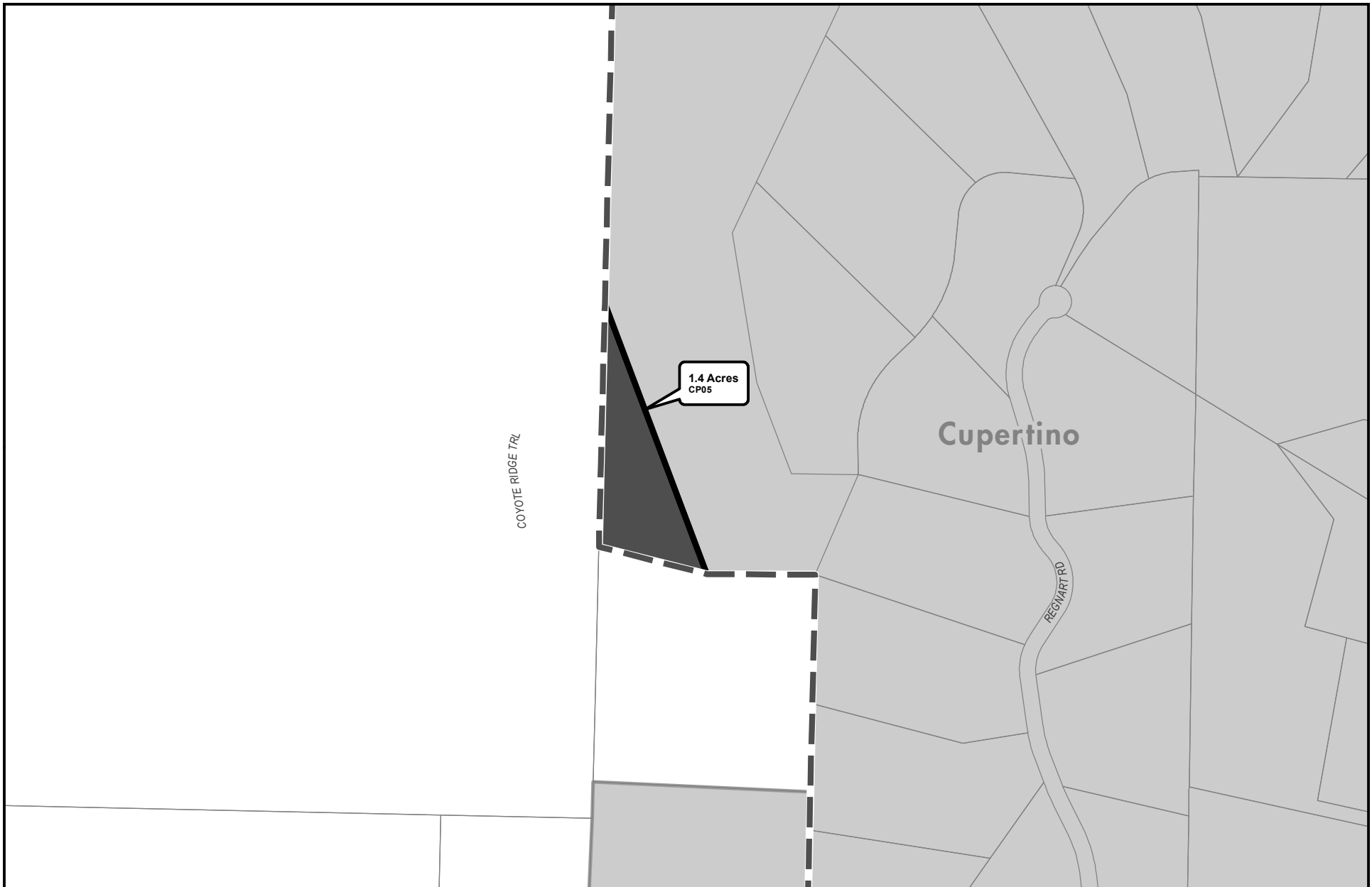

SANTA CLARA COUNTY
Urban Islands 2015

Maps depicting unincorporated lands located
 within the cities' Urban Service Areas (USAs)

Cupertino: Page 4 of 4



Incorporated Areas



Urban Service Area



Urban Island ≤ 150 Acres



Urban Island > 150 Acres

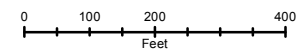

This map created by the Santa Clara County Planning Office. The GIS data was compiled from various sources. While deemed reliable, the Planning Office assumes no liability.
 3/11/2015 9:56:03 AM Y:\Projects\Urban Islands\Urban Islands 2015\UrbanIslands2015_master.mxd



SANTA CLARA COUNTY **Urban Islands 2015**

Maps depicting unincorporated lands located within the cities' Urban Service Areas (USAs)

Gilroy: Page 1 of 4



Incorporated Areas



Urban Service Area



Urban Island \leq 150 Acres



Urban Island $>$ 150 Acres

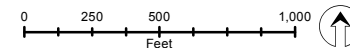

This map created by the Santa Clara County Planning Office. The GIS data was compiled from various sources. While deemed reliable, the Planning Office assumes no liability.

3/11/2015 9:56:03 AM Y:\Projects\Urban Islands\Urban Islands 2015\UrbanIslands2015_master.mxd

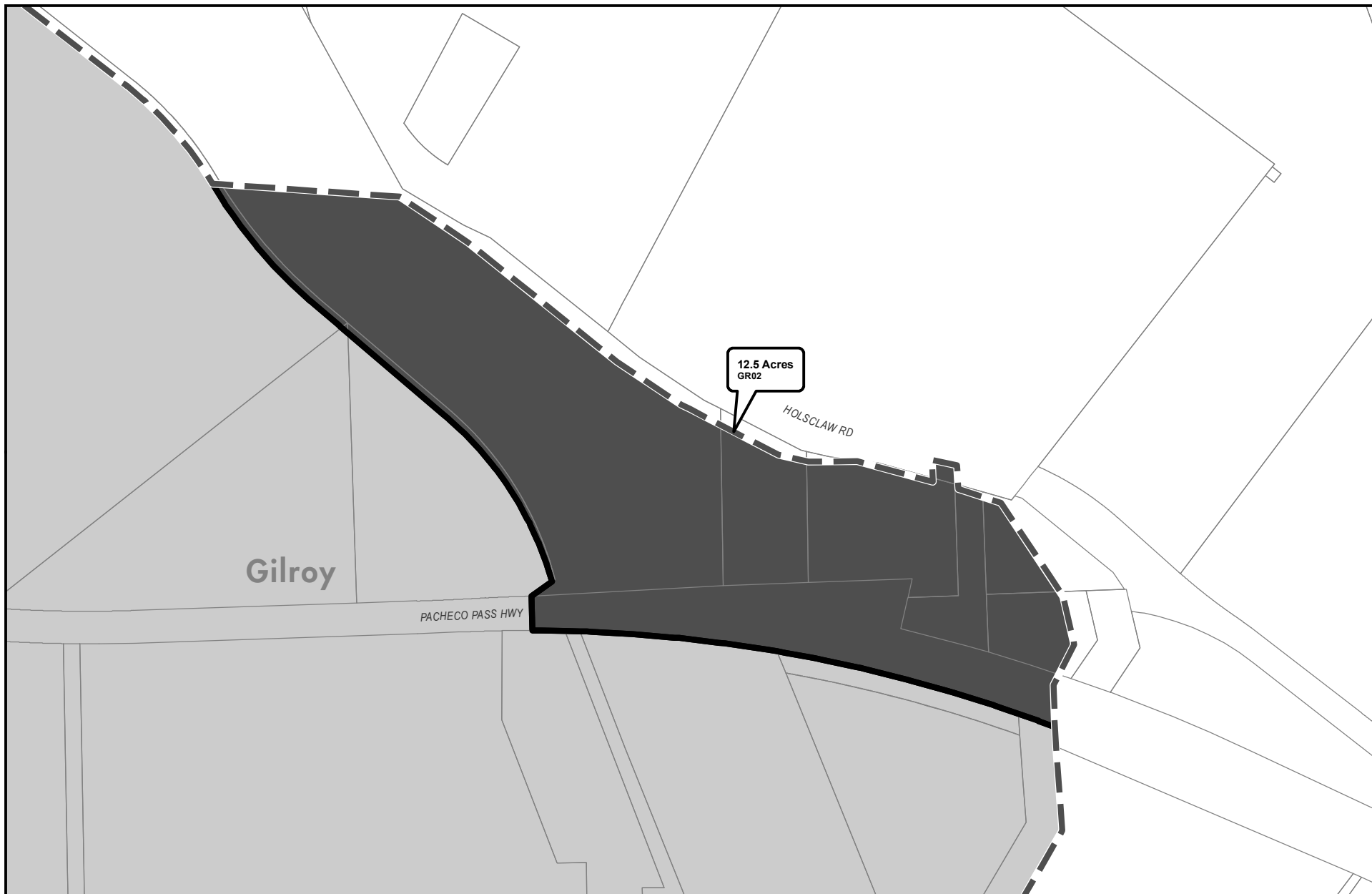

SANTA CLARA COUNTY Urban Islands 2015

Maps depicting unincorporated lands located within the cities' Urban Service Areas (USAs)

Gilroy: Page 2 of 4



Incorporated Areas



Urban Service Area



Urban Island \leq 150 Acres



Urban Island $>$ 150 Acres

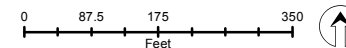

This map created by the Santa Clara County Planning Office. The GIS data was compiled from various sources. While deemed reliable, the Planning Office assumes no liability.
3/11/2015 9:56:03 AM Y:\Projects\Urban Islands\Urban Islands 2015\UrbanIslands2015_master.mxd

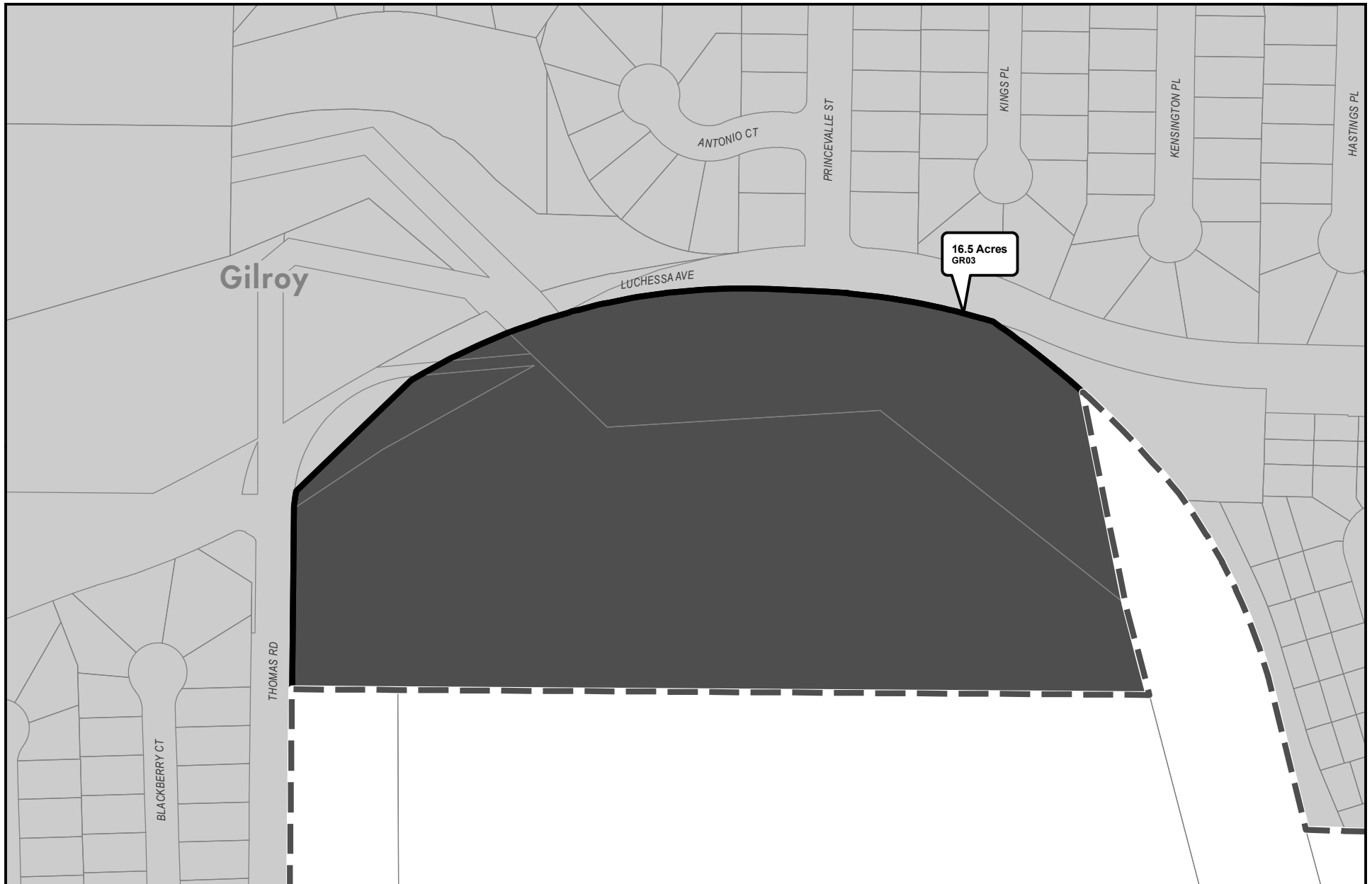

SANTA CLARA COUNTY Urban Islands 2015

Maps depicting unincorporated lands located within the cities' Urban Service Areas (USAs)

Gilroy: Page 3 of 4

 Incorporated Areas

 Urban Service Area

 Urban Island \leq 150 Acres

 Urban Island $>$ 150 Acres

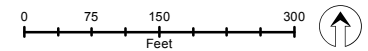

This map created by the Santa Clara County Planning Office. The GIS data was compiled from various sources. While deemed reliable, the Planning Office assumes no liability.
3/11/2015 9:56:03 AM Y:\Projects\Urban Islands\Urban Islands 2015\UrbanIslands2015_master.mxd



SANTA CLARA COUNTY
Urban Islands 2015

Maps depicting unincorporated lands located
 within the cities' Urban Service Areas (USAs)

Gilroy: Page 4 of 4



Incorporated Areas



Urban Service Area



Urban Island ≤ 150 Acres



Urban Island > 150 Acres

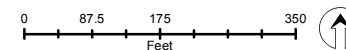

This map created by the Santa Clara County Planning Office. The GIS data was compiled from various sources. While deemed reliable, the Planning Office assumes no liability.
 3/11/2015 9:56:03 AM Y:\Projects\Urban Islands\Urban Islands 2015\UrbanIslands2015_master.mxd



SANTA CLARA COUNTY Urban Islands 2015

Maps depicting unincorporated lands located within the cities' Urban Service Areas (USAs)

Los Altos: Page 1 of 1

- Incorporated Areas
- Urban Island ≤ 150 Acres
- Urban Service Area
- Urban Island > 150 Acres

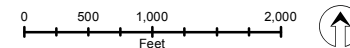

This map created by the Santa Clara County Planning Office. The GIS data was compiled from various sources. While deemed reliable, the Planning Office assumes no liability.

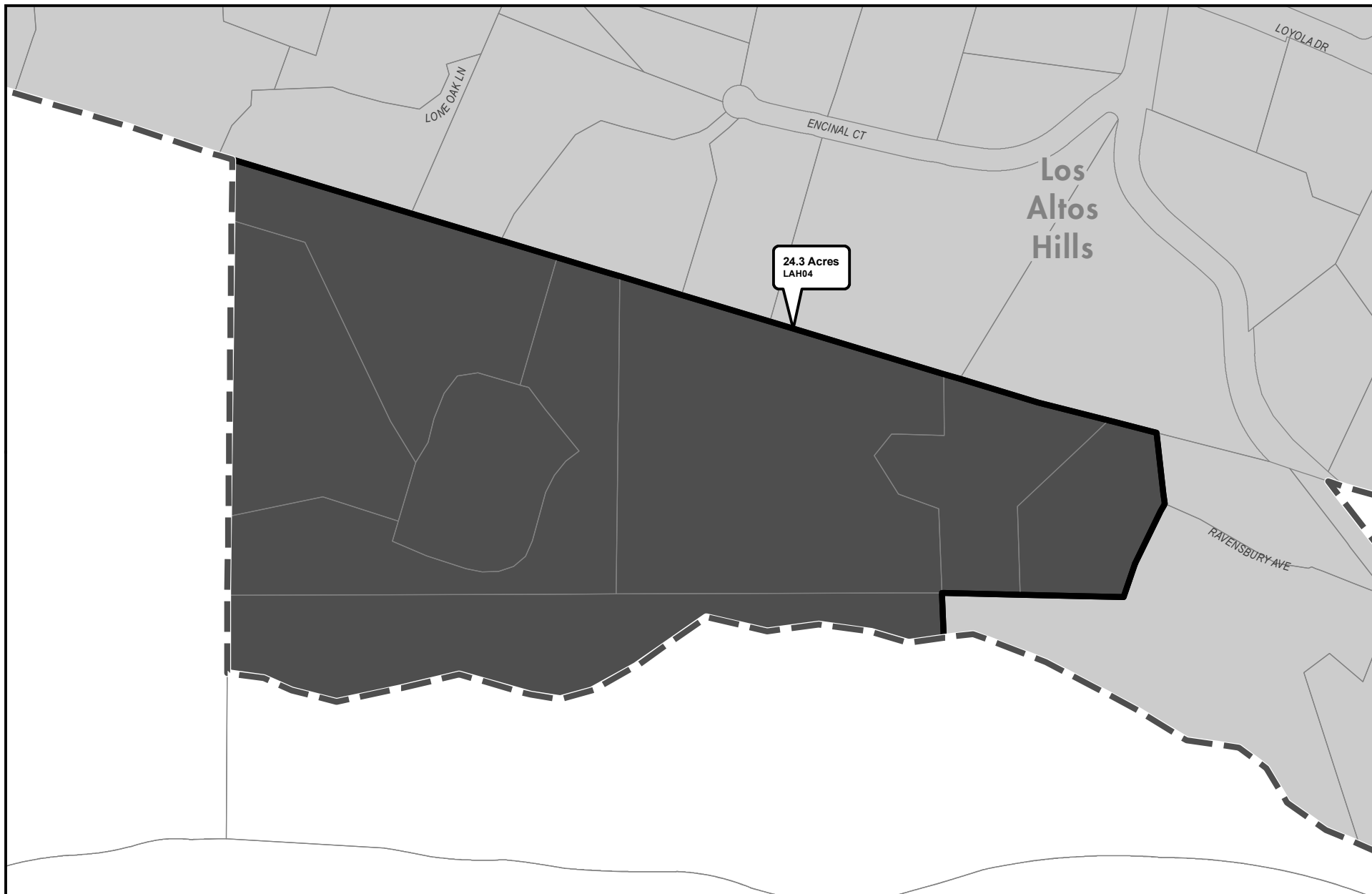

SANTA CLARA COUNTY Urban Islands 2015

Maps depicting unincorporated lands located within the cities' Urban Service Areas (USAs)

Los Altos Hills: Page 1 of 3



Incorporated Areas



Urban Service Area



Urban Island \leq 150 Acres



Urban Island $>$ 150 Acres

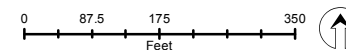

This map created by the Santa Clara County Planning Office. The GIS data was compiled from various sources. While deemed reliable, the Planning Office assumes no liability. 3/11/2015 9:56:03 AM Y:\Projects\Urban Islands\Urban Islands 2015\UrbanIslands2015_master.mxd

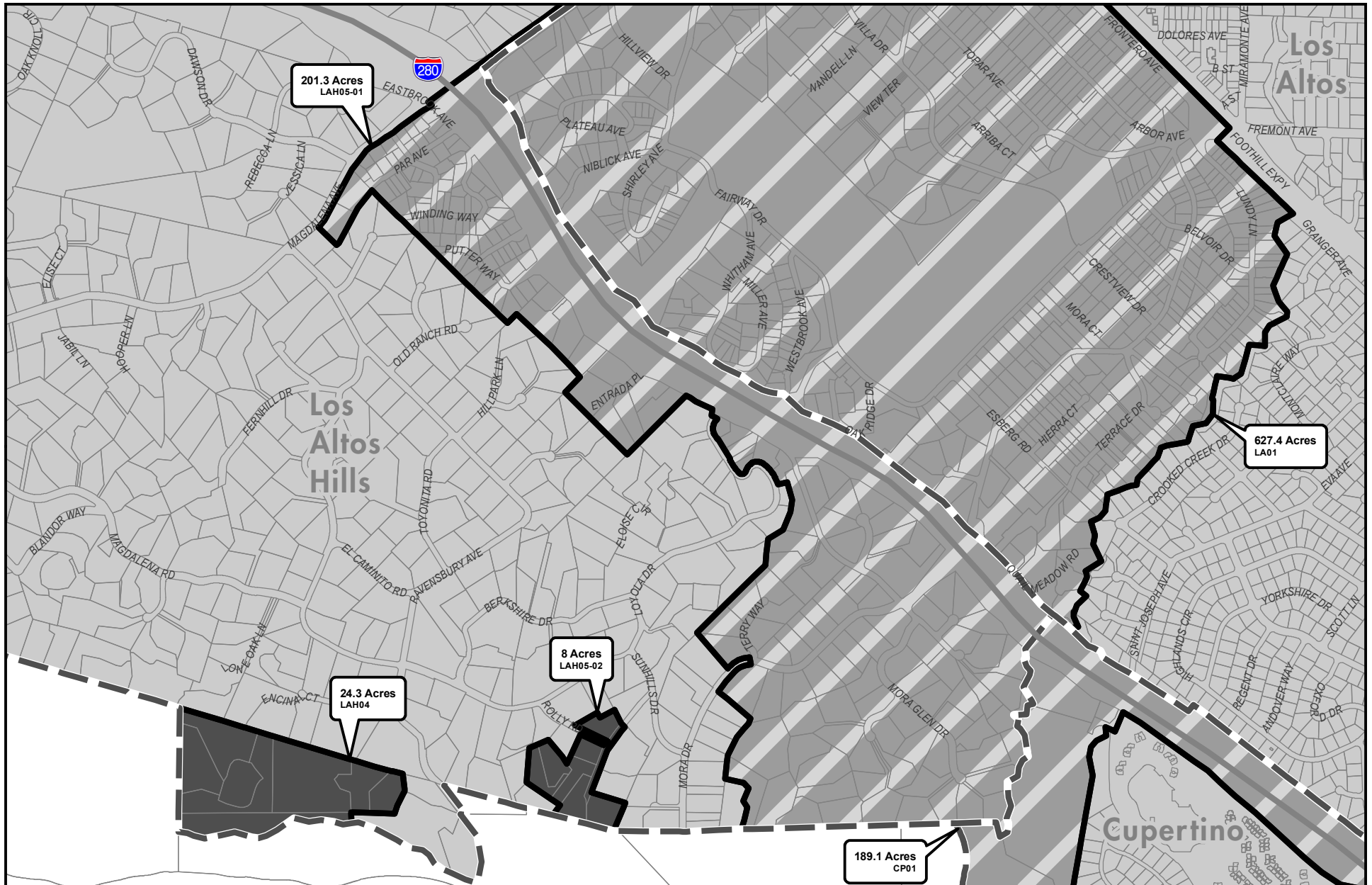

SANTA CLARA COUNTY Urban Islands 2015

Maps depicting unincorporated lands located within the cities' Urban Service Areas (USAs)

Los Altos Hills: Page 2 of 3

 Incorporated Areas

 Urban Service Area

 Urban Island ≤ 150 Acres

 Urban Island > 150 Acres

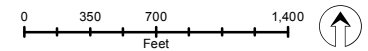

This map created by the Santa Clara County Planning Office. The GIS data was compiled from various sources. While deemed reliable, the Planning Office assumes no liability.



SANTA CLARA COUNTY Urban Islands 2015

Maps depicting unincorporated lands located within the cities' Urban Service Areas (USAs)

Los Altos Hills: Page 3 of 3

 Incorporated Areas

 Urban Service Area

 Urban Island ≤ 150 Acres

 Urban Island > 150 Acres

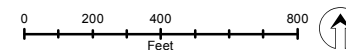

This map created by the Santa Clara County Planning Office. The GIS data was compiled from various sources. While deemed reliable, the Planning Office assumes no liability.
3/11/2015 9:56:03 AM \\P:\Projects\Urban Islands\Urban Islands 2015\UrbanIslands2015_master.mxd



SANTA CLARA COUNTY Urban Islands 2015

Maps depicting unincorporated lands located within the cities' Urban Service Areas (USAs)

Los Gatos: Page 1 of 6

 Incorporated Areas

 Urban Service Area

 Urban Island \leq 150 Acres

 Urban Island $>$ 150 Acres

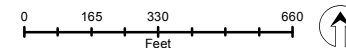

This map created by the Santa Clara County Planning Office. The GIS data was compiled from various sources. While deemed reliable, the Planning Office assumes no liability.
3/11/2015 9:56:03 AM \\P:\Projects\Urban Islands\Urban Islands 2015\UrbanIslands2015_master.mxd



SANTA CLARA COUNTY Urban Islands 2015

Maps depicting unincorporated lands located within the cities' Urban Service Areas (USAs)

Los Gatos: Page 2 of 6

 Incorporated Areas

 Urban Service Area

 Urban Island ≤ 150 Acres

 Urban Island > 150 Acres

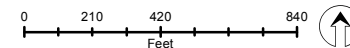

This map created by the Santa Clara County Planning Office. The GIS data was compiled from various sources. While deemed reliable, the Planning Office assumes no liability.

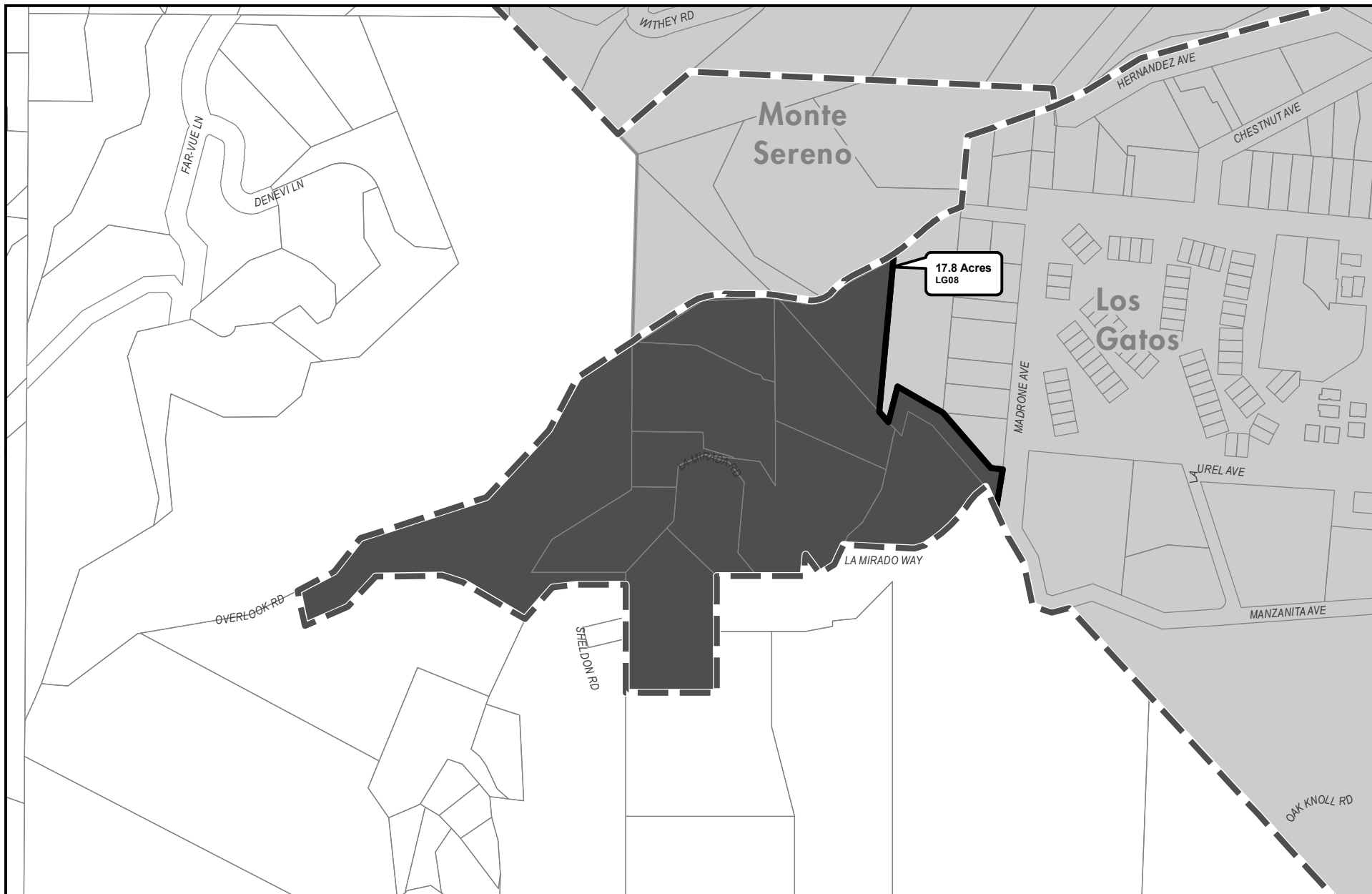

SANTA CLARA COUNTY Urban Islands 2015

Maps depicting unincorporated lands located within the cities' Urban Service Areas (USAs)

Los Gatos: Page 3 of 6

 Incorporated Areas

 Urban Service Area

 Urban Island \leq 150 Acres

 Urban Island $>$ 150 Acres

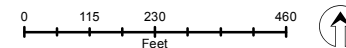

This map created by the Santa Clara County Planning Office. The GIS data was compiled from various sources. While deemed reliable, the Planning Office assumes no liability. 3/11/2015 9:56:03 AM Y:\Projects\Urban Islands\Urban Islands 2015\UrbanIslands2015_master.mxd

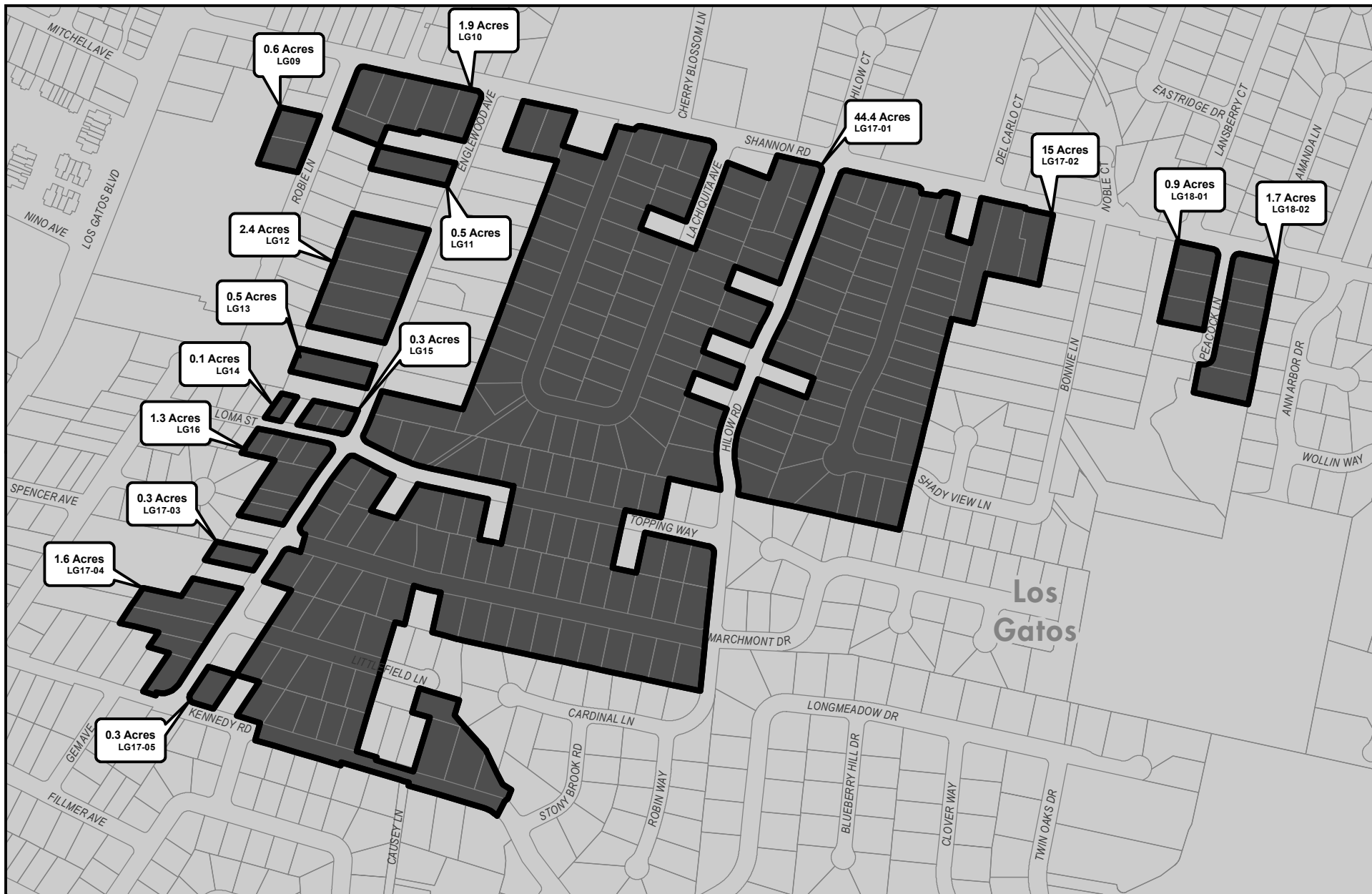

SANTA CLARA COUNTY **Urban Islands 2015**

Maps depicting unincorporated lands located within the cities' Urban Service Areas (USAs)

Los Gatos: Page 4 of 6

 Incorporated Areas

 Urban Service Area

 Urban Island ≤ 150 Acres

 Urban Island > 150 Acres

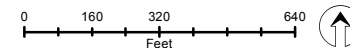

This map created by the Santa Clara County Planning Office. The GIS data was compiled from various sources. While deemed reliable, the Planning Office assumes no liability.

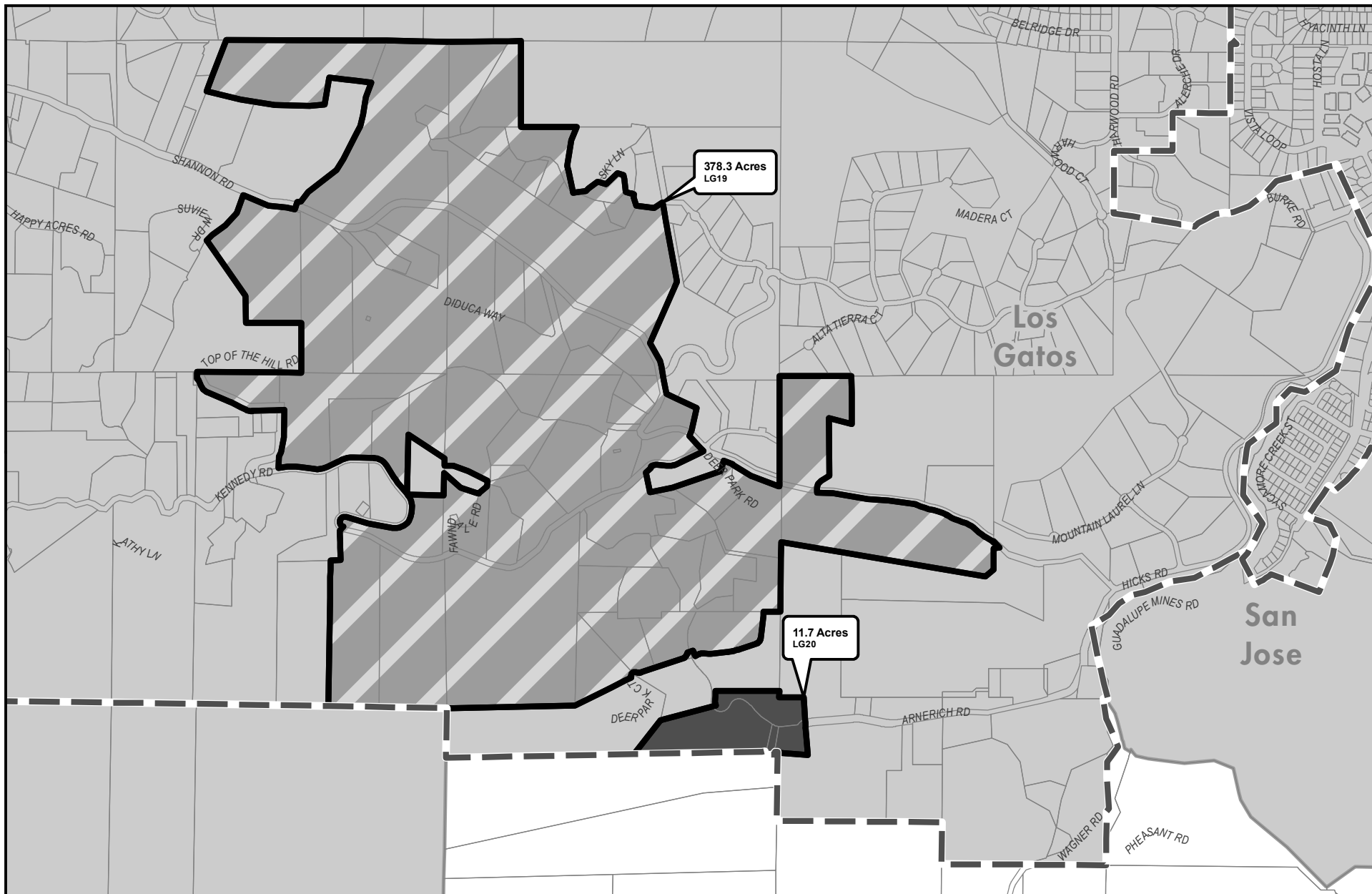

SANTA CLARA COUNTY Urban Islands 2015

Maps depicting unincorporated lands located within the cities' Urban Service Areas (USAs)

Los Gatos: Page 5 of 6

 Incorporated Areas

 Urban Service Area

 Urban Island ≤ 150 Acres

 Urban Island > 150 Acres

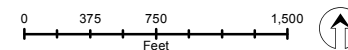

This map created by the Santa Clara County Planning Office. The GIS data was compiled from various sources. While deemed reliable, the Planning Office assumes no liability.

3/11/2015 9:56:03 AM Y:\Projects\Urban Islands\Urban Islands 2015\UrbanIslands2015_master.mxd

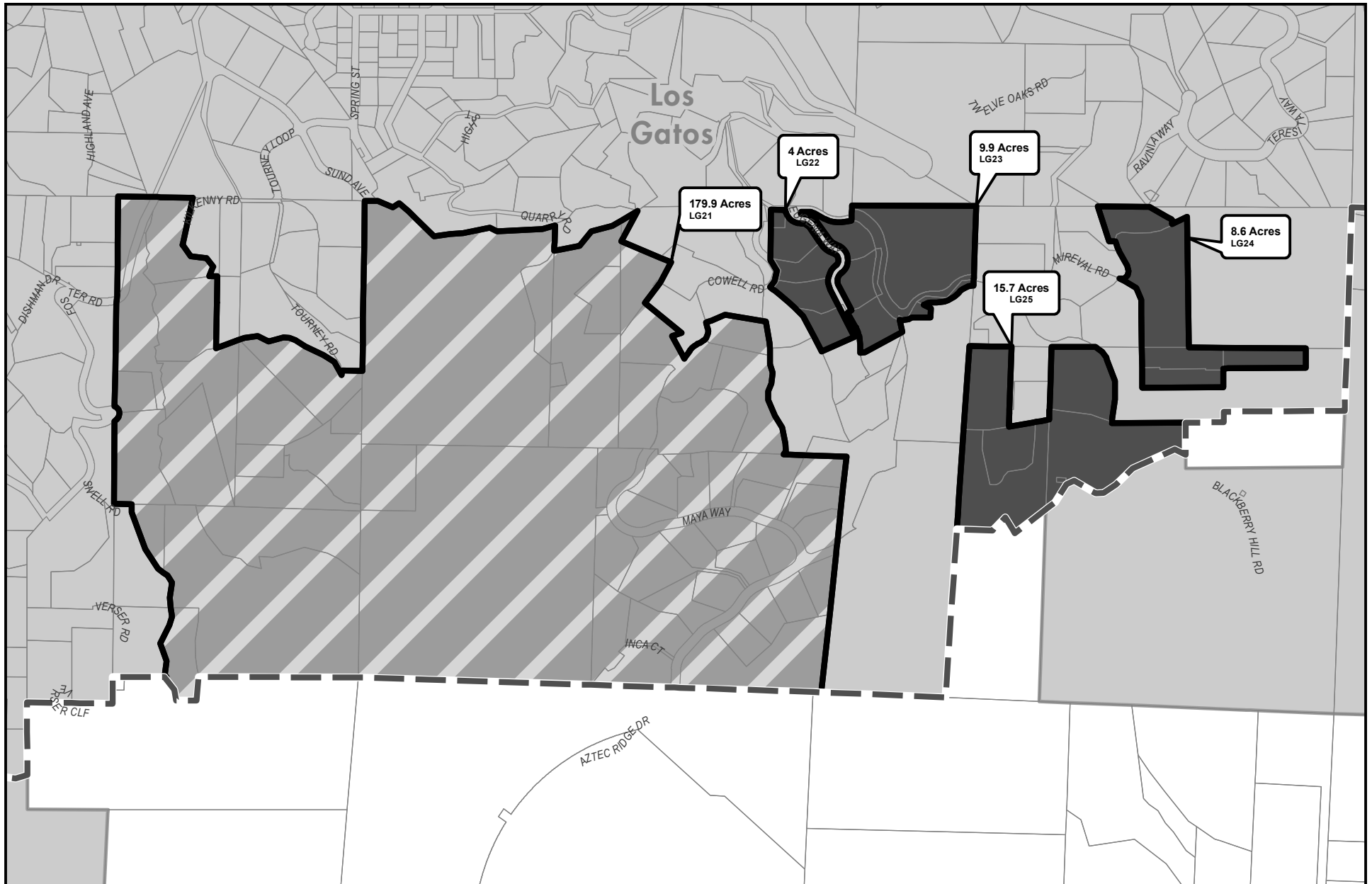

SANTA CLARA COUNTY Urban Islands 2015

Maps depicting unincorporated lands located
within the cities' Urban Service Areas (USAs)

Los Gatos: Page 6 of 6

 Incorporated Areas

 Urban Service Area

 Urban Island ≤ 150 Acres

 Urban Island > 150 Acres

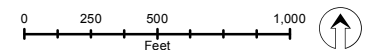

This map created by the Santa Clara County Planning Office. The GIS data was compiled from various sources. While deemed reliable, the Planning Office assumes no liability.
3/11/2015 9:56:03 AM Y:\Projects\Urban Islands\Urban Islands 2015\UrbanIslands2015_master.mxd

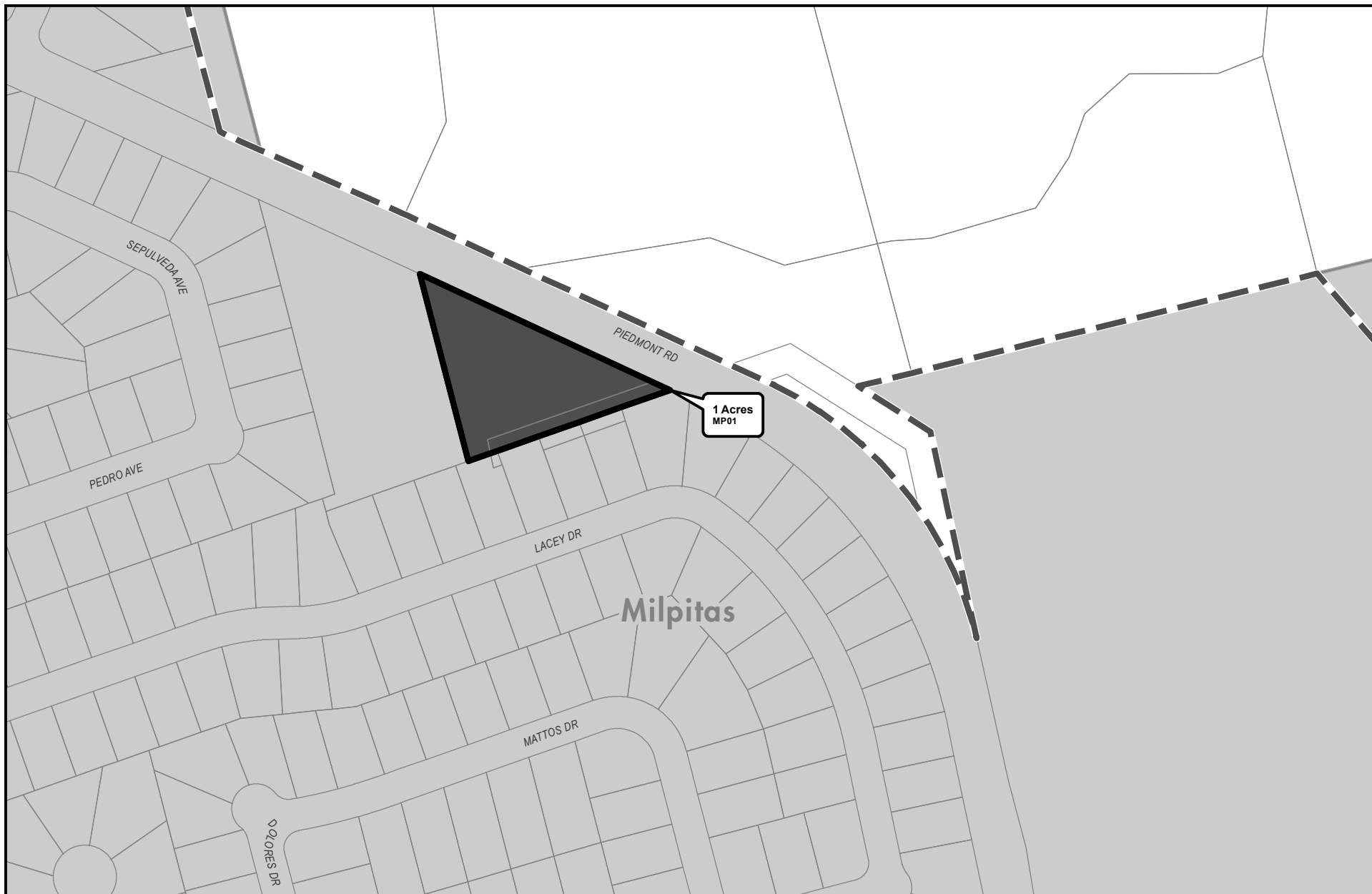

SANTA CLARA COUNTY
Urban Islands 2015

Maps depicting unincorporated lands located
 within the cities' Urban Service Areas (USAs)

Milpitas: Page 1 of 1



Incorporated Areas



Urban Service Area



Urban Island \leq 150 Acres



Urban Island $>$ 150 Acres

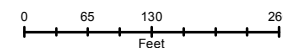

This map created by the Santa Clara County Planning Office. The GIS data was compiled from various sources. While deemed reliable, the Planning Office assumes no liability.
 3/11/2015 9:56:03 AM Y:\Projects\Urban Islands\Urban Islands 2015\UrbanIslands2015_master.mxd



SANTA CLARA COUNTY
Urban Islands 2015

Maps depicting unincorporated lands located
 within the cities' Urban Service Areas (USAs)

Monte Sereno: Page 1 of 2



Incorporated Areas



Urban Service Area



Urban Island \leq 150 Acres



Urban Island $>$ 150 Acres

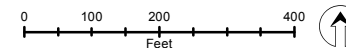

This map created by the Santa Clara County Planning Office. The GIS data was compiled from various sources. While deemed reliable, the Planning Office assumes no liability.
 3/11/2015 9:56:03 AM Y:\Projects\Urban Islands\Urban Islands 2015\UrbanIslands2015_master.mxd

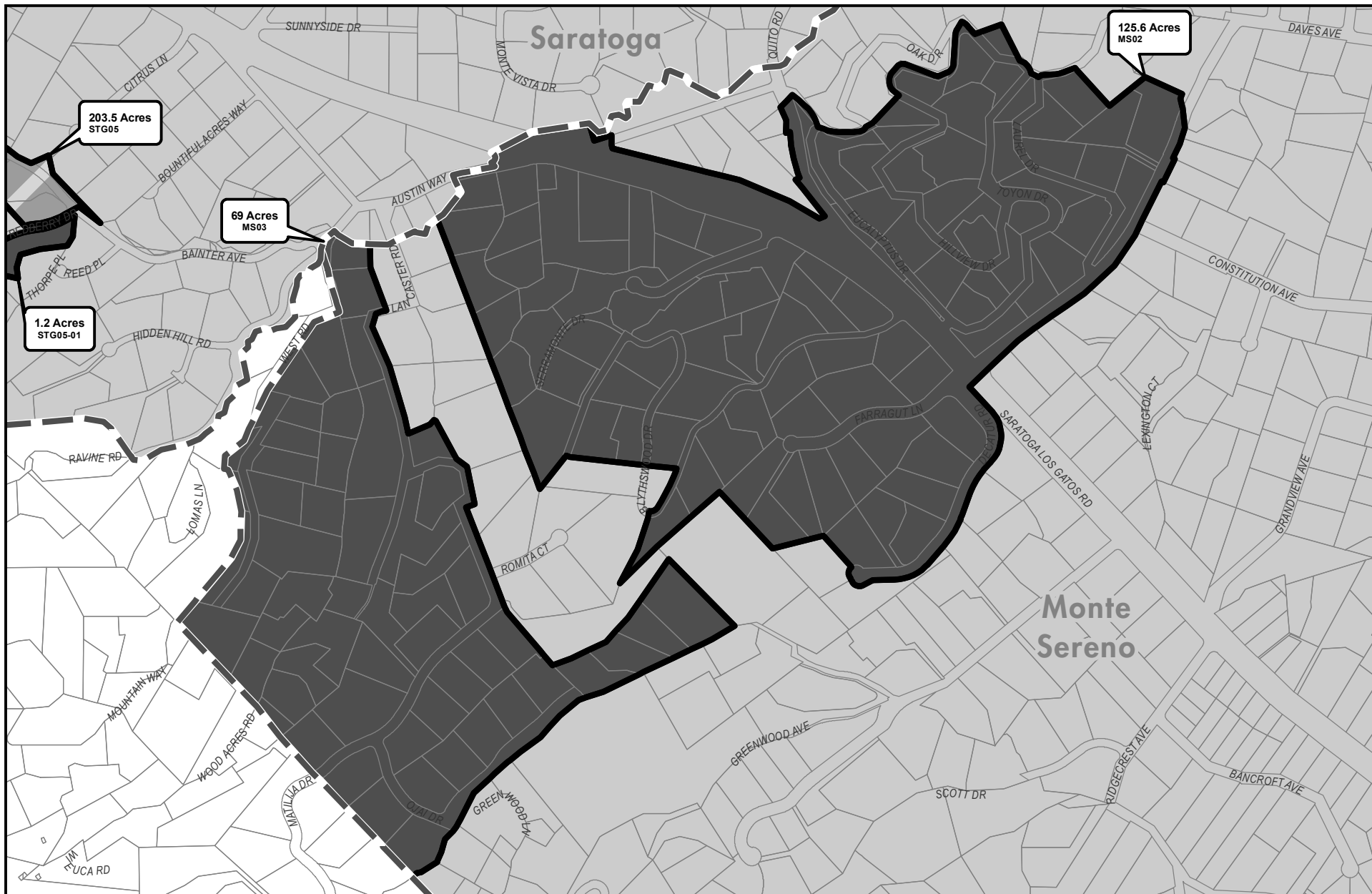

SANTA CLARA COUNTY **Urban Islands 2015**

Maps depicting unincorporated lands located within the cities' Urban Service Areas (USAs)

Monte Sereno: Page 2 of 2

 Incorporated Areas

 Urban Service Area

 Urban Island ≤ 150 Acres

 Urban Island > 150 Acres

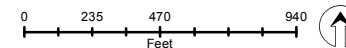

This map created by the Santa Clara County Planning Office. The GIS data was compiled from various sources. While deemed reliable, the Planning Office assumes no liability.

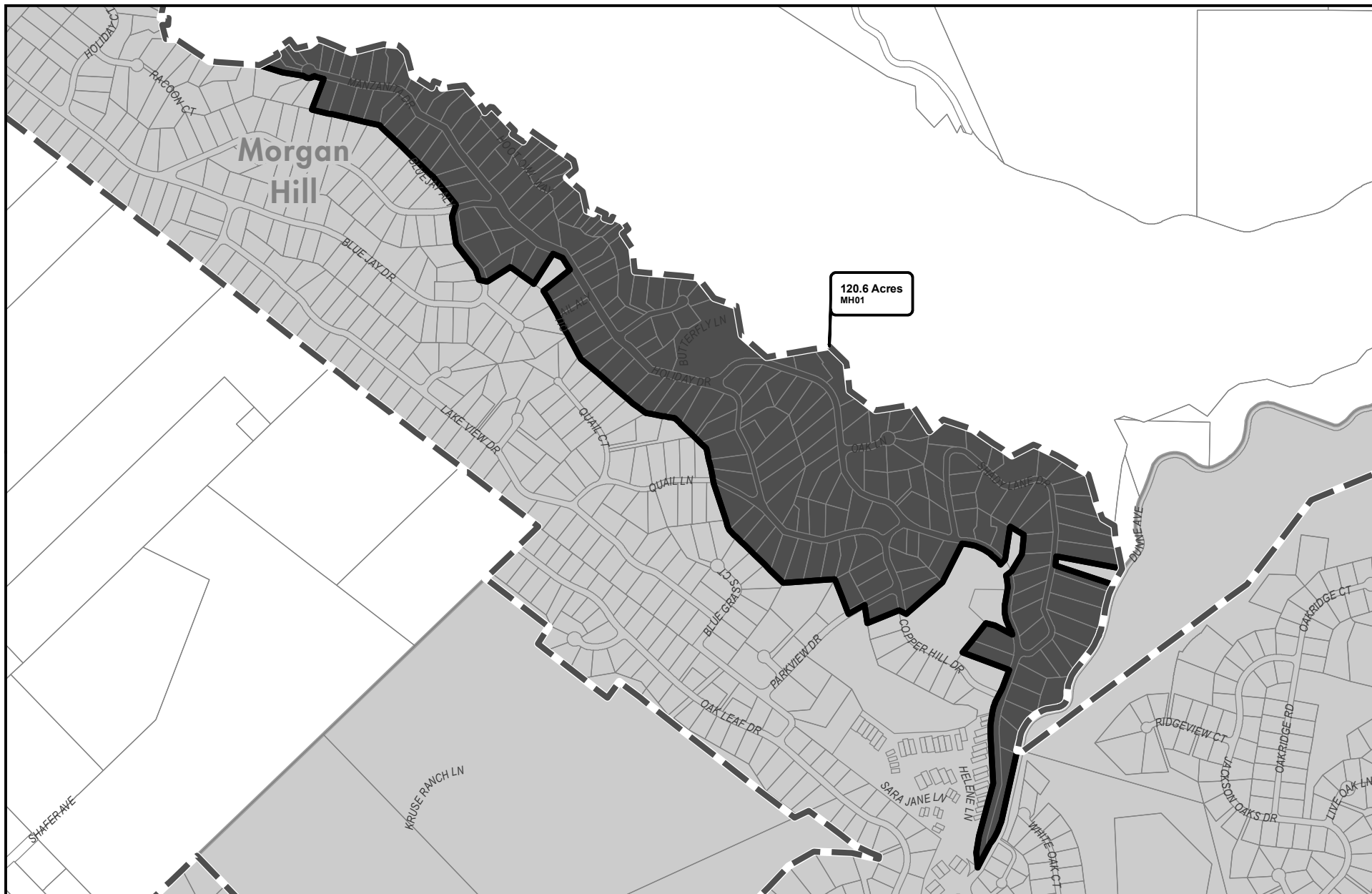

SANTA CLARA COUNTY Urban Islands 2015

Maps depicting unincorporated lands located within the cities' Urban Service Areas (USAs)

Morgan Hill: Page 1 of 2

 Incorporated Areas

 Urban Service Area

 Urban Island \leq 150 Acres

 Urban Island $>$ 150 Acres

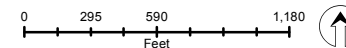

This map created by the Santa Clara County Planning Office. The GIS data was compiled from various sources. While deemed reliable, the Planning Office assumes no liability.
3/11/2015 9:56:03 AM Y:\Projects\Urban Islands\Urban Islands 2015\UrbanIslands2015_master.mxd



SANTA CLARA COUNTY Urban Islands 2015

Maps depicting unincorporated lands located within the cities' Urban Service Areas (USAs)

Morgan Hill: Page 2 of 2

 Incorporated Areas

 Urban Service Area

 Urban Island \leq 150 Acres

 Urban Island $>$ 150 Acres

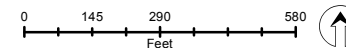

This map created by the Santa Clara County Planning Office. The GIS data was compiled from various sources. While deemed reliable, the Planning Office assumes no liability. 3/11/2015 9:56:03 AM Y:\Projects\Urban Islands\Urban Islands 2015\UrbanIslands2015_master.mxd



SANTA CLARA COUNTY Urban Islands 2015

Maps depicting unincorporated lands located within the cities' Urban Service Areas (USAs)

Palo Alto: Page 1 of 1



SANTA CLARA COUNTY Urban Islands 2015

Maps depicting unincorporated lands located
within the cities' Urban Service Areas (USAs)

San Jose: Page 1 of 18

 Incorporated Areas

 Urban Service Area

 Urban Island \leq 150 Acres

 Urban Island $>$ 150 Acres

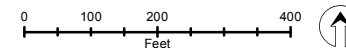

This map created by the Santa Clara County Planning Office. The GIS data was compiled from various sources. While deemed reliable, the Planning Office assumes no liability.
3/11/2015 9:56:03 AM Y:\Projects\Urban Islands\Urban Islands 2015\UrbanIslands2015_master.mxd



SANTA CLARA COUNTY Urban Islands 2015

Maps depicting unincorporated lands located within the cities' Urban Service Areas (USAs)

San Jose: Page 2 of 18

 Incorporated Areas

 Urban Service Area

 Urban Island ≤ 150 Acres

 Urban Island > 150 Acres

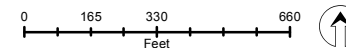

This map created by the Santa Clara County Planning Office. The GIS data was compiled from various sources. While deemed reliable, the Planning Office assumes no liability.
3/11/2015 9:56:03 AM V:\Projects\Urban Islands\Urban Islands 2015\UrbanIslands015_master.mxd



SANTA CLARA COUNTY Urban Islands 2015

Maps depicting unincorporated lands located
within the cities' Urban Service Areas (USAs)

San Jose: Page 3 of 18

 Incorporated Areas

 Urban Service Area

 Urban Island \leq 150 Acres

 Urban Island $>$ 150 Acres

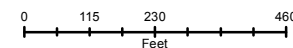

This map created by the Santa Clara County Planning Office. The GIS data was compiled from various sources. While deemed reliable, the Planning Office assumes no liability. 3/11/2015 9:56:03 AM \\P:\Projects\Urban Islands\Urban Islands 2015\UrbanIslands2015_master.mxd

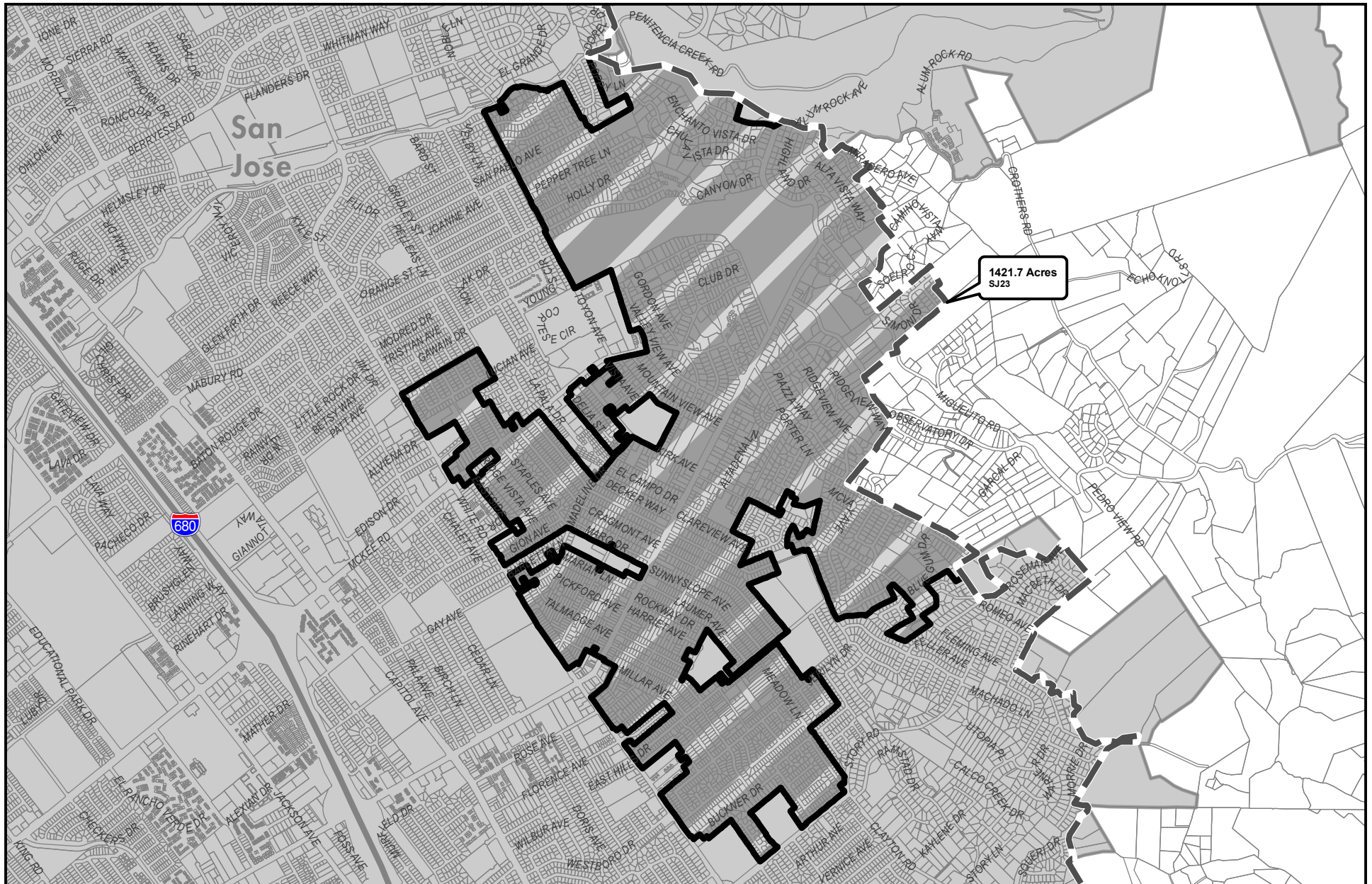

SANTA CLARA COUNTY **Urban Islands 2015**

Maps depicting unincorporated lands located within the cities' Urban Service Areas (USAs)

San Jose: Page 4 of 18

This map created by the Santa Clara County Planning Office. The GIS data was compiled from various sources. While deemed reliable, the Planning Office assumes no liability.

Page 30 of 52



SANTA CLARA COUNTY Urban Islands 2015

Maps depicting unincorporated lands located within the cities' Urban Service Areas (USAs)

San Jose: Page 5 of 18

 Incorporated Areas

 Urban Service Area

 Urban Island ≤ 150 Acres

 Urban Island > 150 Acres

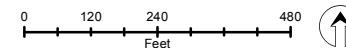

This map created by the Santa Clara County Planning Office. The GIS data was compiled from various sources. While deemed reliable, the Planning Office assumes no liability.
3/11/2015 9:56:03 AM Y:\Projects\Urban Islands\Urban Islands 2015\UrbanIslands2015_master.mxd

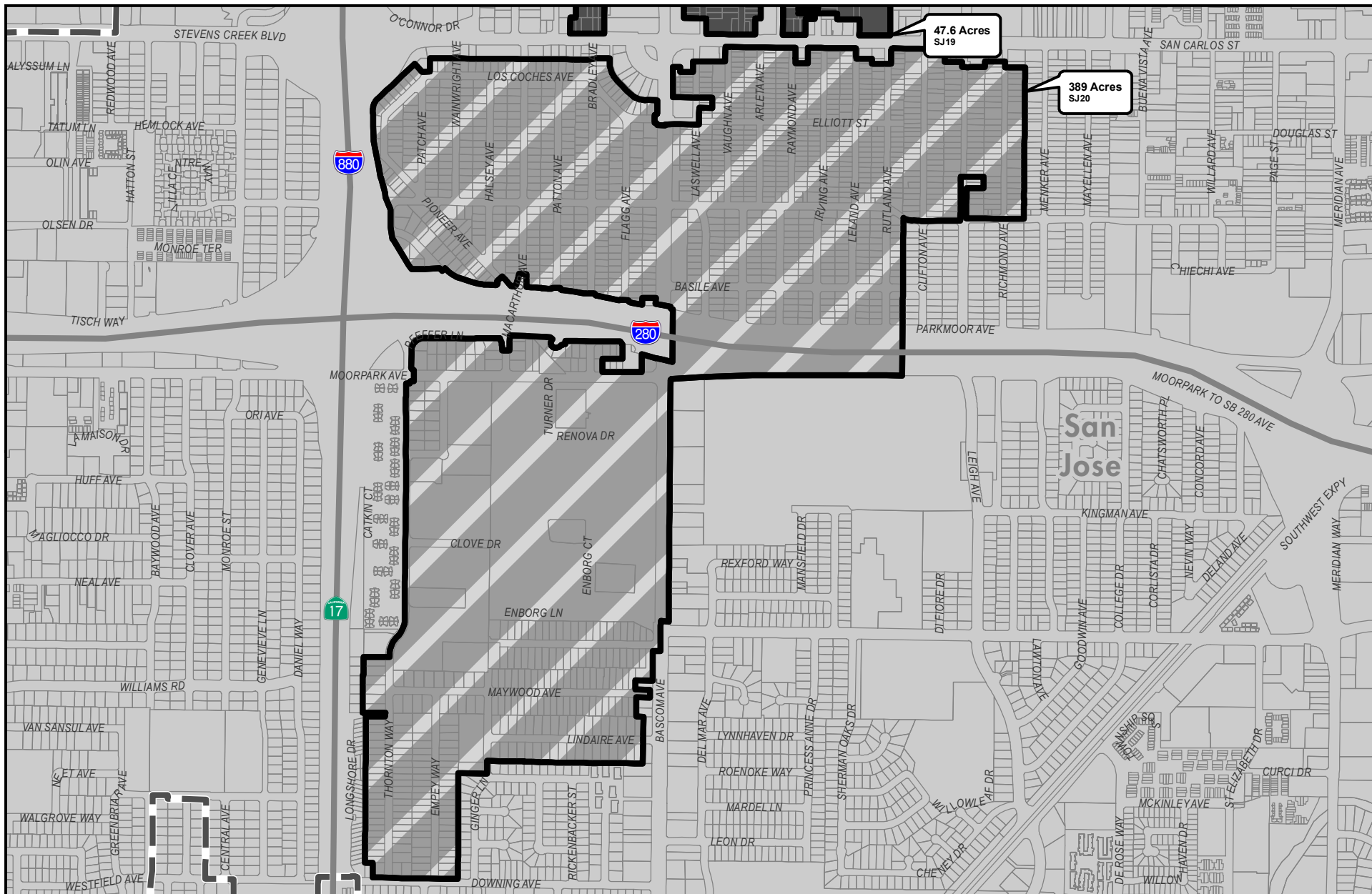

SANTA CLARA COUNTY Urban Islands 2015

Maps depicting unincorporated lands located within the cities' Urban Service Areas (USAs)

San Jose: Page 6 of 18

 Incorporated Areas

 Urban Service Area

 Urban Island ≤ 150 Acres

 Urban Island > 150 Acres

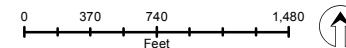

This map created by the Santa Clara County Planning Office. The GIS data was compiled from various sources. While deemed reliable, the Planning Office assumes no liability.



113.8 Acres
SJ09

San
Jose

SANTA CLARA COUNTY Urban Islands 2015

Maps depicting unincorporated lands located
within the cities' Urban Service Areas (USAs)

San Jose: Page 7 of 18



Incorporated Areas



Urban Service Area



Urban Island \leq 150 Acres



Urban Island $>$ 150 Acres

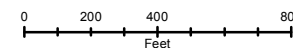

This map created by the Santa Clara County Planning Office. The GIS data was compiled
from various sources. While deemed reliable, the Planning Office assumes no liability.
3/11/2015 9:56:03 AM \\P:\Projects\Urban Islands\Urban Islands 2015\UrbanIslands2015_master.mxd



SANTA CLARA COUNTY Urban Islands 2015

Maps depicting unincorporated lands located within the cities' Urban Service Areas (USAs)

San Jose: Page 8 of 18

 Incorporated Areas

 Urban Service Area

 Urban Island \leq 150 Acres

 Urban Island $>$ 150 Acres

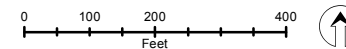

This map created by the Santa Clara County Planning Office. The GIS data was compiled from various sources. While deemed reliable, the Planning Office assumes no liability.
3/11/2015 9:56:03 AM Y:\Projects\Urban Islands\Urban Islands 2015\UrbanIslands0115_master.mxd



SANTA CLARA COUNTY Urban Islands 2015

Maps depicting unincorporated lands located within the cities' Urban Service Areas (USAs)

San Jose: Page 9 of 18

 Incorporated Areas

 Urban Service Area

 Urban Island \leq 150 Acres

 Urban Island $>$ 150 Acres

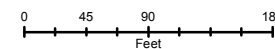

This map created by the Santa Clara County Planning Office. The GIS data was compiled from various sources. While deemed reliable, the Planning Office assumes no liability.
3/11/2015 9:56:03 AM Y:\Projects\Urban Islands\Urban Islands 2015\UrbanIslands0115_master.mxd

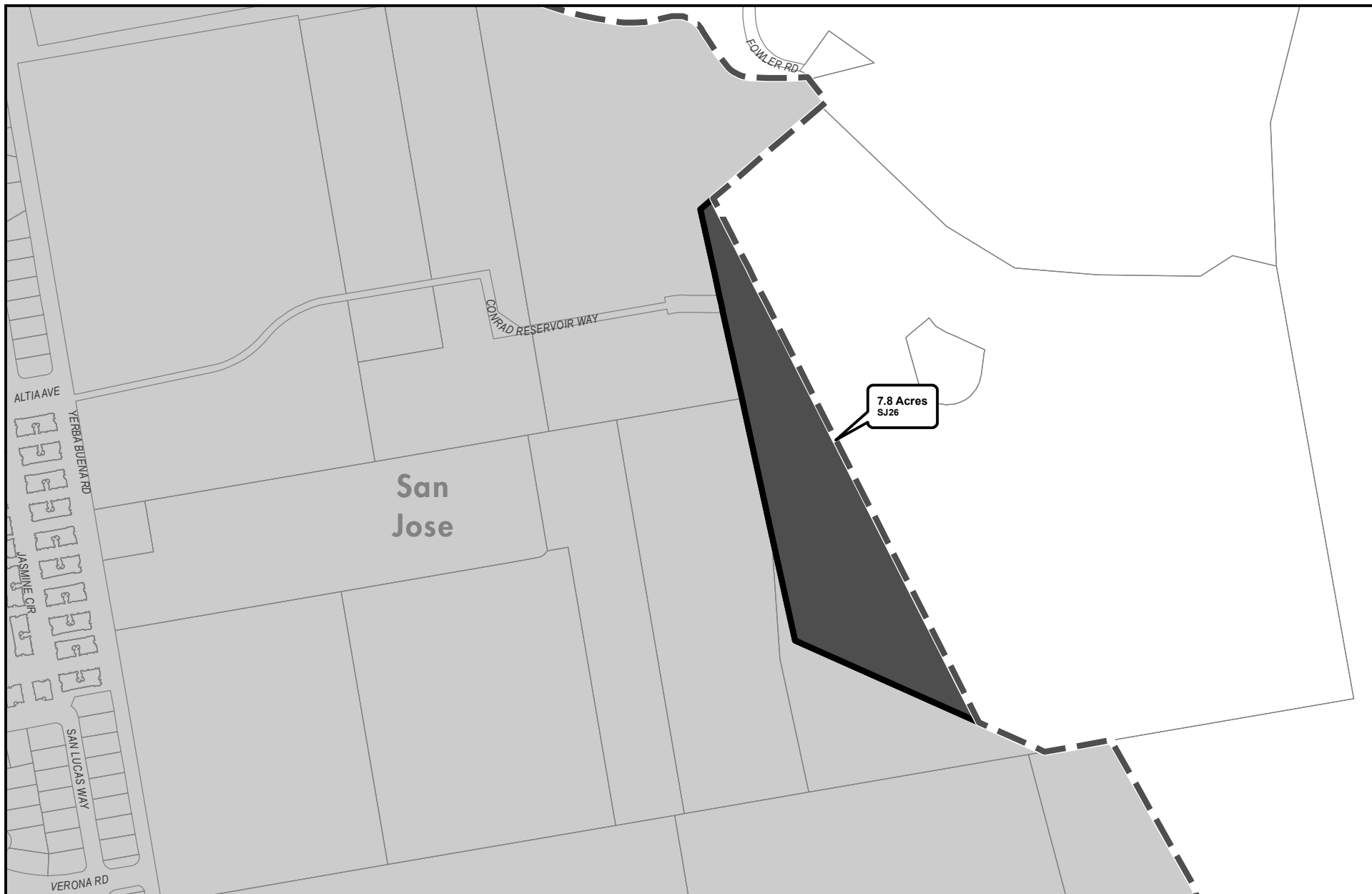

SANTA CLARA COUNTY Urban Islands 2015

Maps depicting unincorporated lands located within the cities' Urban Service Areas (USAs)

San Jose: Page 10 of 18



Incorporated Areas



Urban Service Area



Urban Island \leq 150 Acres



Urban Island $>$ 150 Acres

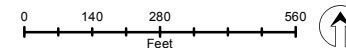

This map created by the Santa Clara County Planning Office. The GIS data was compiled from various sources. While deemed reliable, the Planning Office assumes no liability.
3/11/2015 9:56:03 AM Y:\Projects\Urban Islands\Urban Islands 2015\UrbanIslands2015_master.mxd

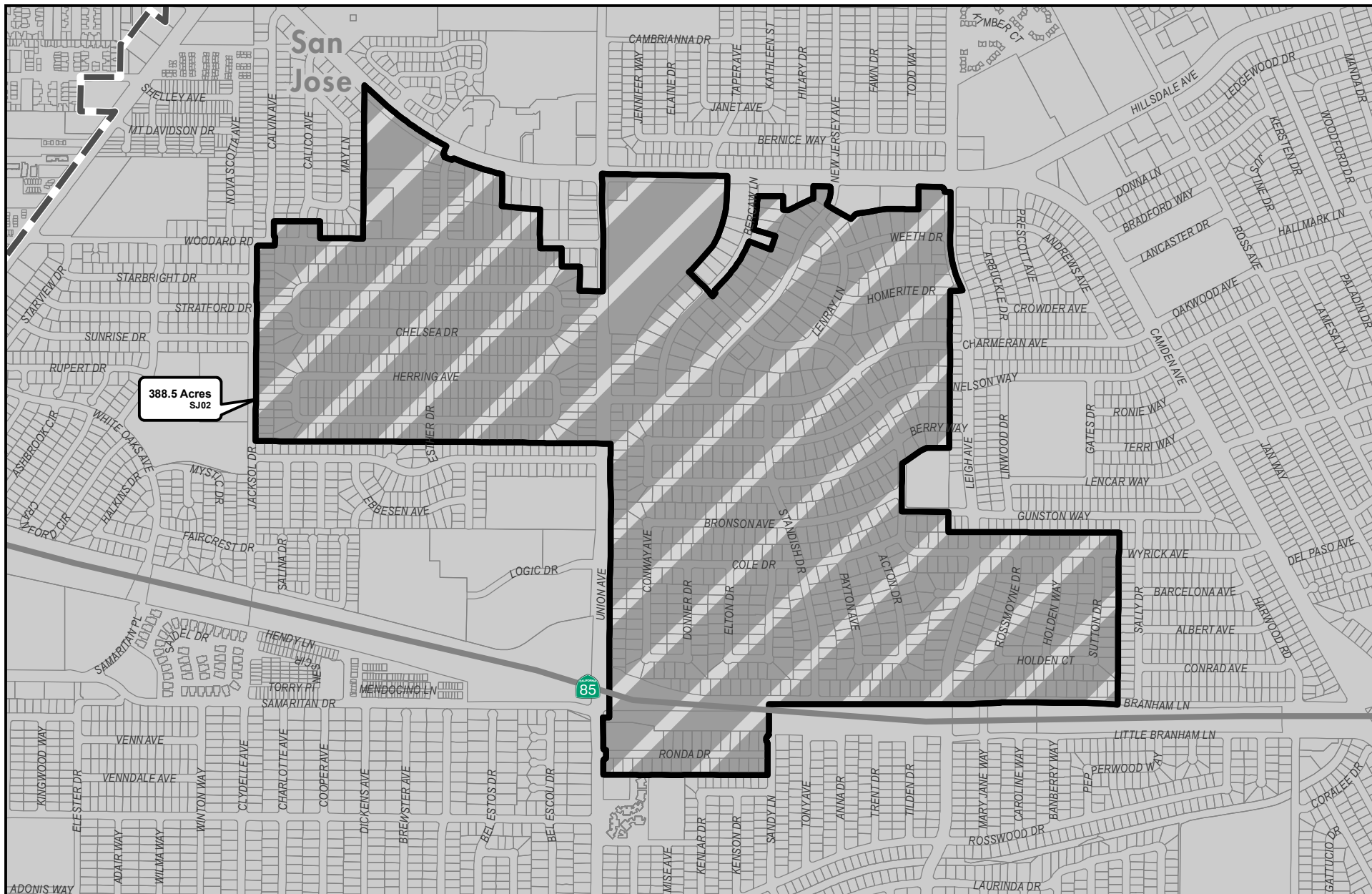

388.5 Acres
SJ02

85

SANTA CLARA COUNTY Urban Islands 2015

Maps depicting unincorporated lands located within the cities' Urban Service Areas (USAs)

San Jose: Page 11 of 18

 Incorporated Areas

 Urban Service Area

 Urban Island ≤ 150 Acres

 Urban Island > 150 Acres

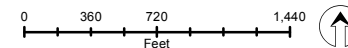

This map created by the Santa Clara County Planning Office. The GIS data was compiled from various sources. While deemed reliable, the Planning Office assumes no liability.



SANTA CLARA COUNTY **Urban Islands 2015**

Maps depicting unincorporated lands located within the cities' Urban Service Areas (USAs)

San Jose: Page 12 of 18



Incorporated Areas



Urban Service Area



Urban Island \leq 150 Acres



Urban Island $>$ 150 Acres

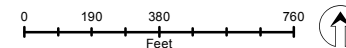

This map created by the Santa Clara County Planning Office. The GIS data was compiled from various sources. While deemed reliable, the Planning Office assumes no liability.

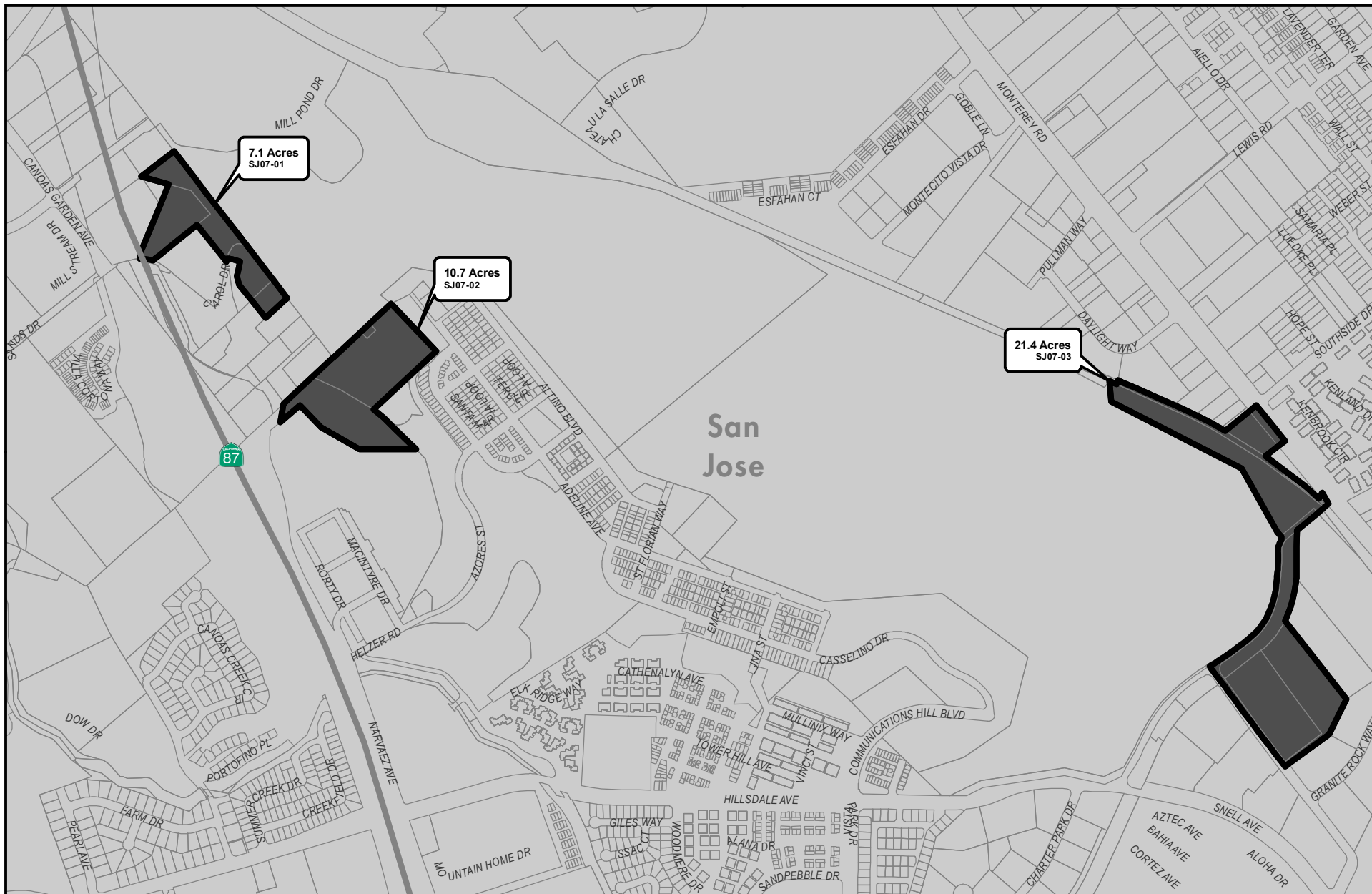

SANTA CLARA COUNTY Urban Islands 2015

Maps depicting unincorporated lands located within the cities' Urban Service Areas (USAs)

San Jose: Page 13 of 18



Incorporated Areas



Urban Service Area



Urban Island ≤ 150 Acres



Urban Island > 150 Acres

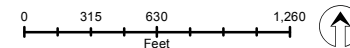

This map created by the Santa Clara County Planning Office. The GIS data was compiled from various sources. While deemed reliable, the Planning Office assumes no liability.

3/11/2015 9:56:03 AM Y:\Projects\Urban Islands\Urban Islands 2015\UrbanIslands2015_master.mxd

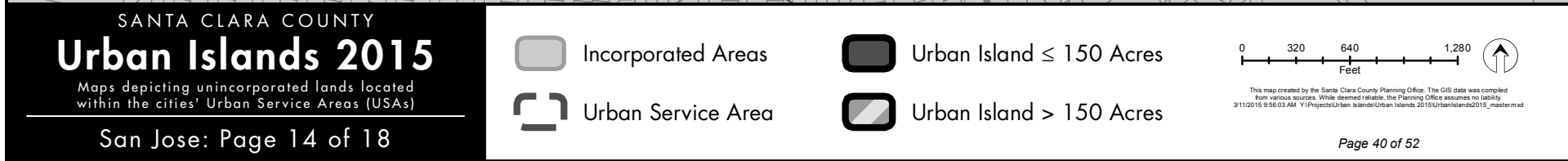

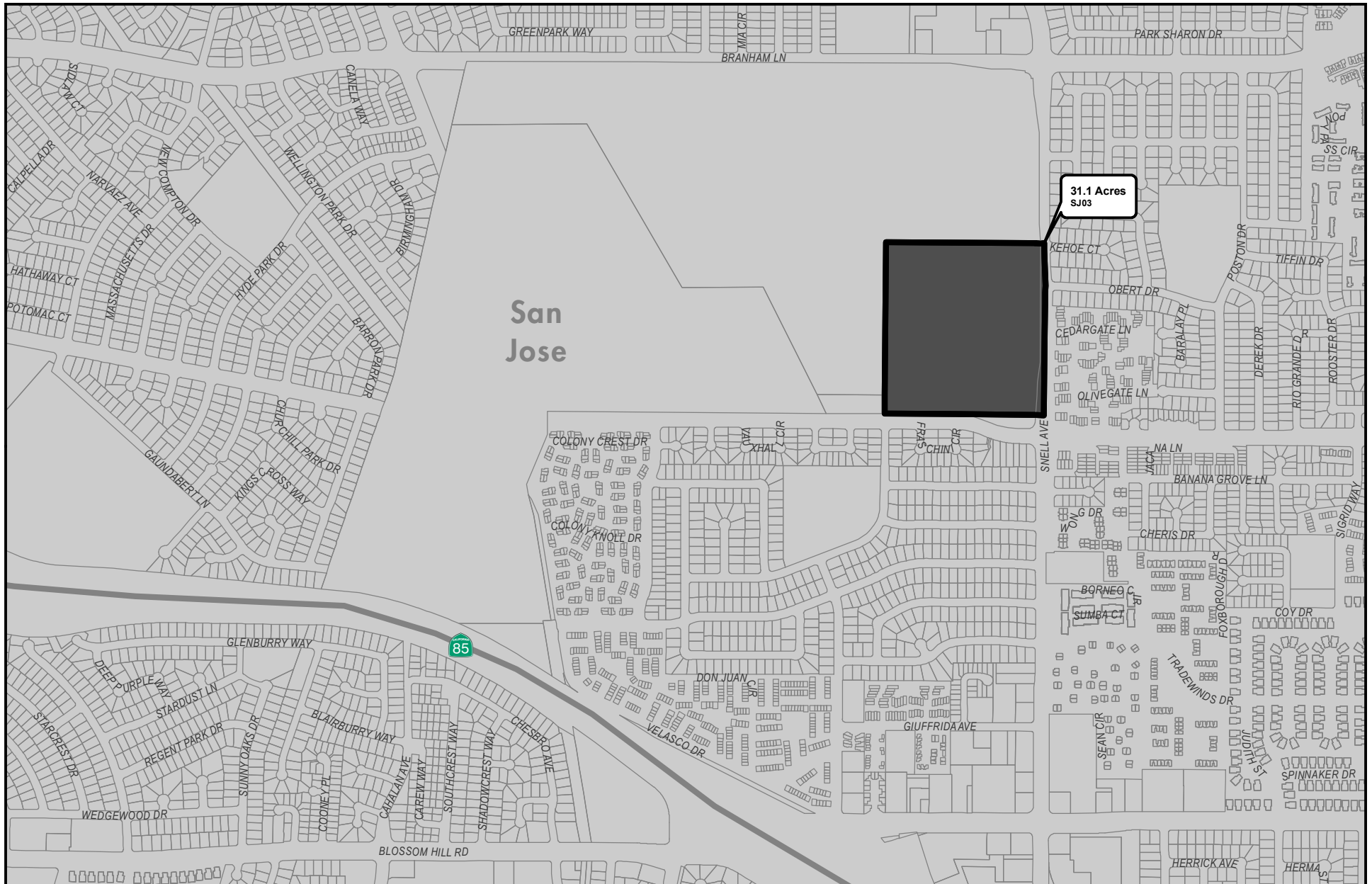

SANTA CLARA COUNTY Urban Islands 2015

Maps depicting unincorporated lands located within the cities' Urban Service Areas (USAs)

San Jose: Page 15 of 18

 Incorporated Areas

 Urban Service Area

 Urban Island ≤ 150 Acres

 Urban Island > 150 Acres

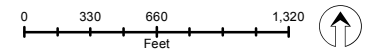

This map created by the Santa Clara County Planning Office. The GIS data was compiled from various sources. While deemed reliable, the Planning Office assumes no liability.



SANTA CLARA COUNTY **Urban Islands 2015**

Maps depicting unincorporated lands located within the cities' Urban Service Areas (USAs)

San Jose: Page 16 of 18

 Incorporated Areas

 Urban Service Area

 Urban Island \leq 150 Acres

 Urban Island $>$ 150 Acres

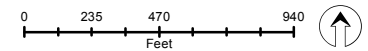

This map created by the Santa Clara County Planning Office. The GIS data was compiled from various sources. While deemed reliable, the Planning Office assumes no liability.
3/11/2015 9:56:03 AM Y:\Projects\Urban Islands\Urban Islands 2015\UrbanIslands2015_master.mxd

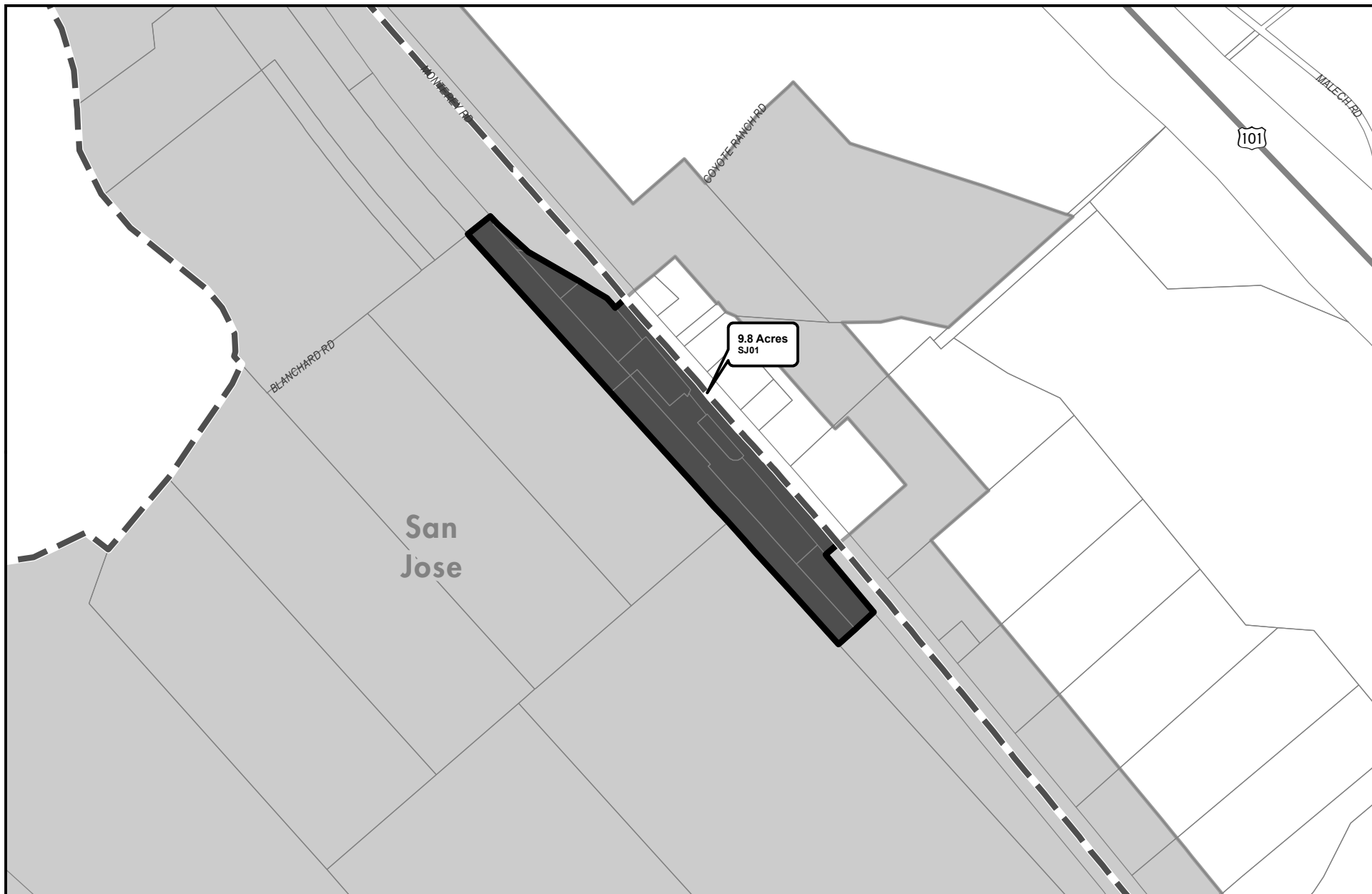

SANTA CLARA COUNTY
Urban Islands 2015

Maps depicting unincorporated lands located
 within the cities' Urban Service Areas (USAs)

San Jose: Page 17 of 18



Incorporated Areas



Urban Service Area



Urban Island \leq 150 Acres



Urban Island $>$ 150 Acres

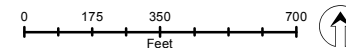

This map created by the Santa Clara County Planning Office. The GIS data was compiled from various sources. While deemed reliable, the Planning Office assumes no liability.
 3/11/2015 9:56:03 AM Y:\Projects\Urban Islands\Urban Islands 2015\UrbanIslands2015_master.mxd

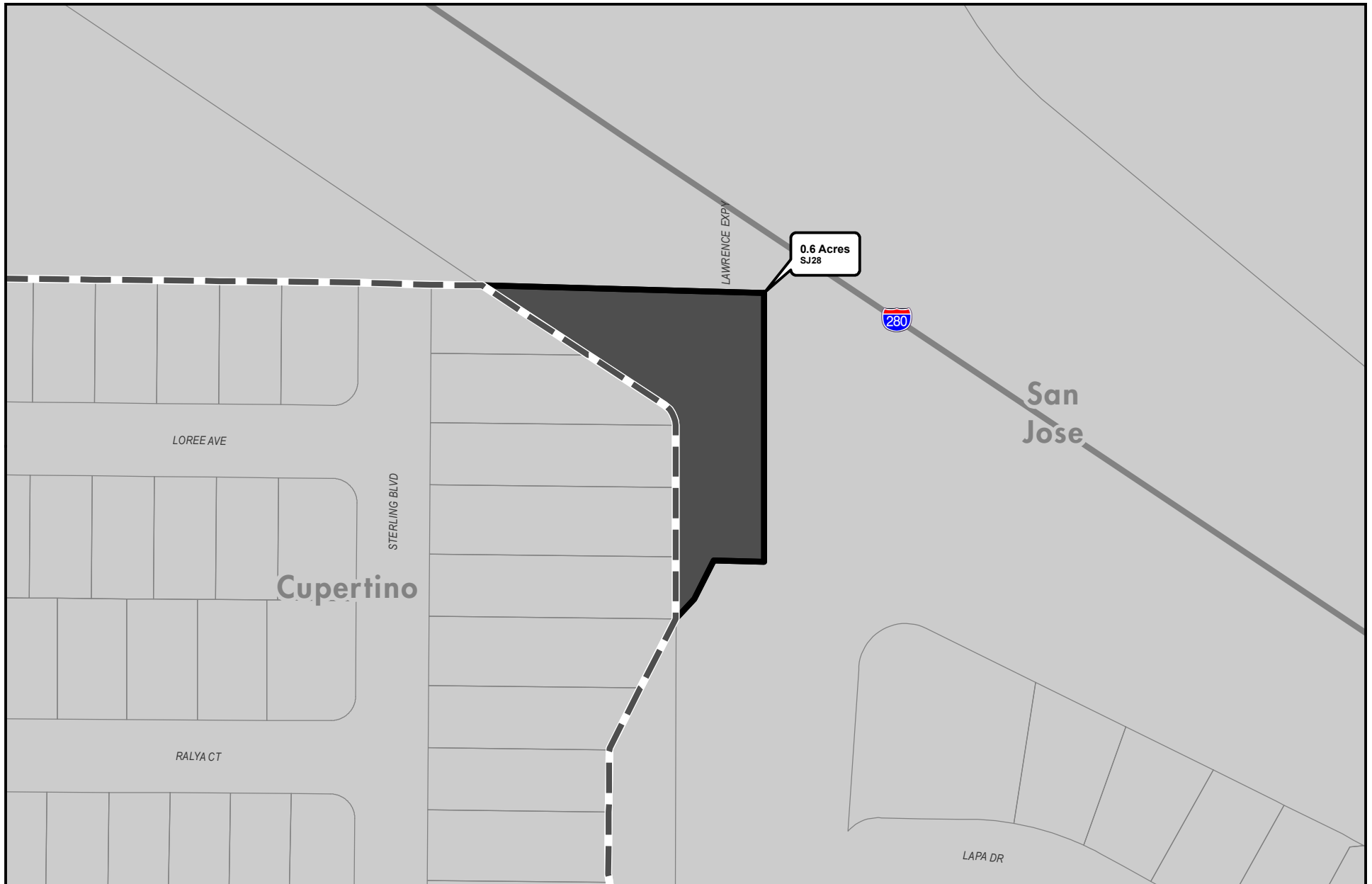

SANTA CLARA COUNTY
Urban Islands 2015

Maps depicting unincorporated lands located
within the cities' Urban Service Areas (USAs)

San Jose: Page 18 of 18

 Incorporated Areas

 Urban Service Area

 Urban Island ≤ 150 Acres

 Urban Island > 150 Acres

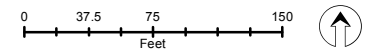

This map created by the Santa Clara County Planning Office. The GIS data was compiled from various sources. While deemed reliable, the Planning Office assumes no liability.
3/11/2015 9:56:03 AM Y:\Projects\Urban Islands\Urban Islands 2015\UrbanIslands2015_master.mxd

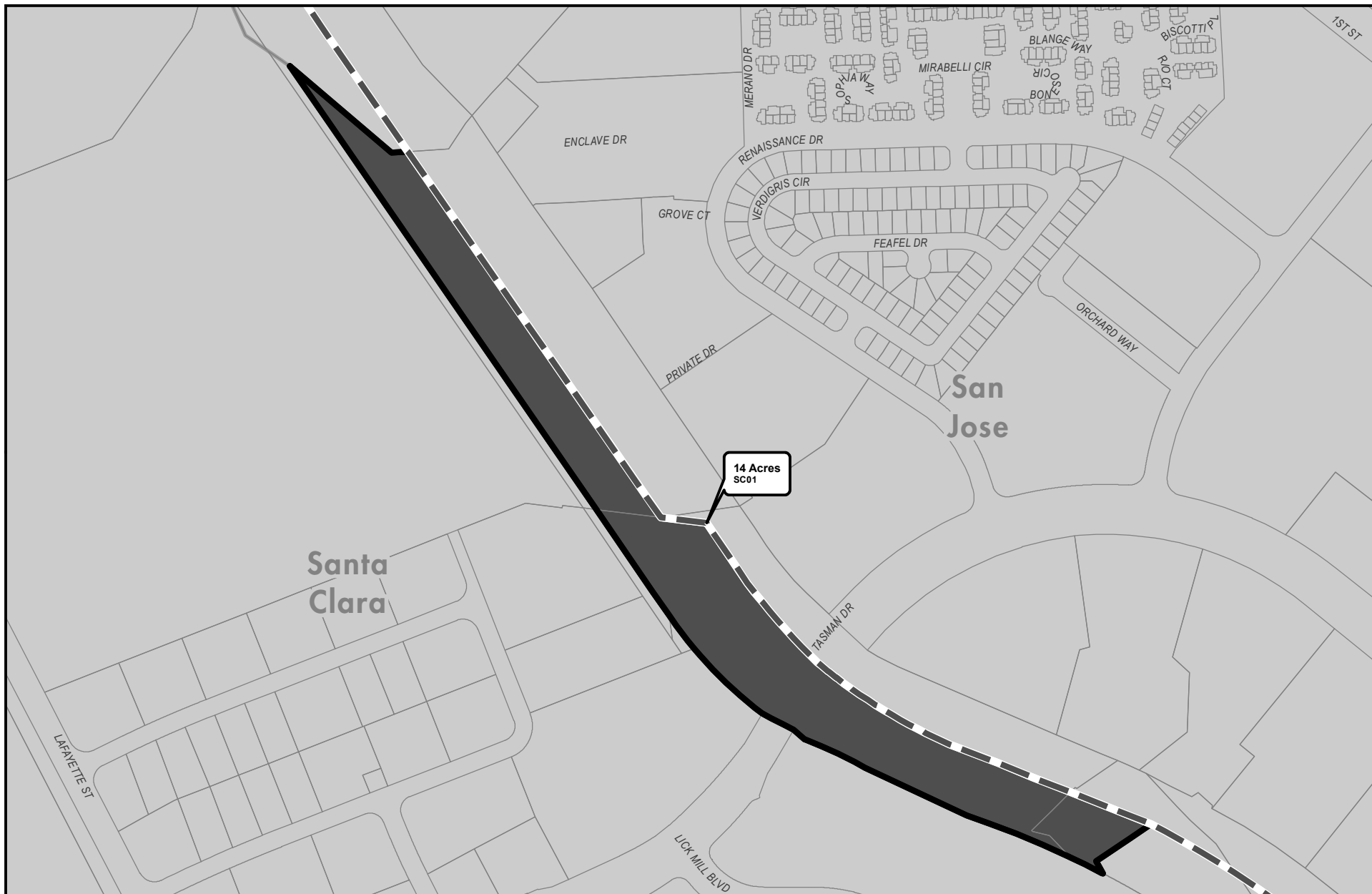

SANTA CLARA COUNTY Urban Islands 2015

Maps depicting unincorporated lands located within the cities' Urban Service Areas (USAs)

Santa Clara: Page 1 of 5



Incorporated Areas



Urban Service Area



Urban Island \leq 150 Acres



Urban Island $>$ 150 Acres

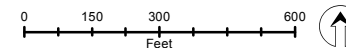

This map created by the Santa Clara County Planning Office. The GIS data was compiled from various sources. While deemed reliable, the Planning Office assumes no liability.

3/11/2015 9:56:03 AM Y:\Projects\Urban Islands\Urban Islands 2015\UrbanIslands2015_master.mxd

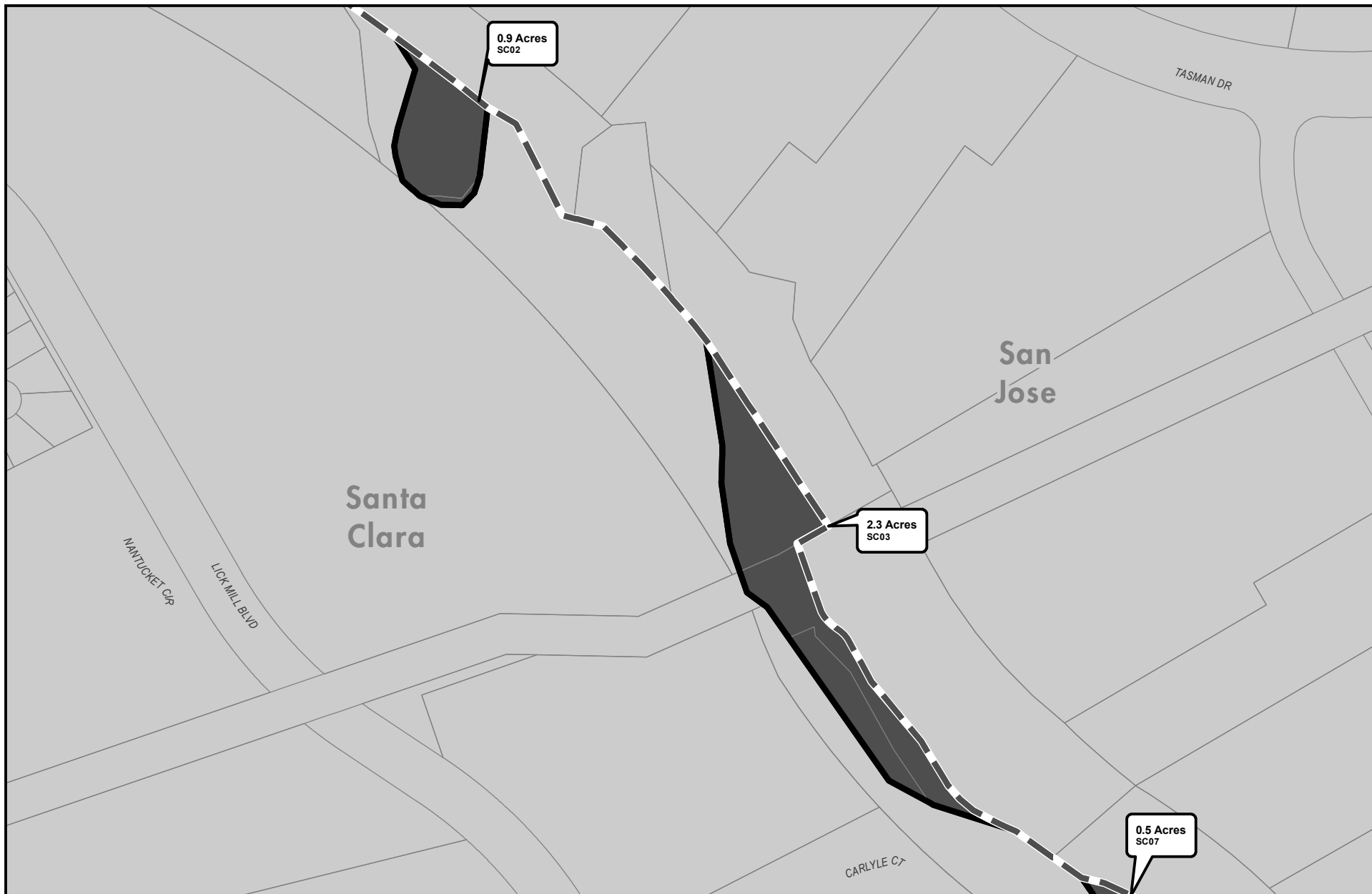

SANTA CLARA COUNTY Urban Islands 2015

Maps depicting unincorporated lands located within the cities' Urban Service Areas (USAs)

Santa Clara: Page 2 of 5

 Incorporated Areas

 Urban Service Area

 Urban Island ≤ 150 Acres

 Urban Island > 150 Acres

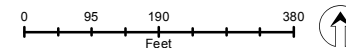

This map created by the Santa Clara County Planning Office. The GIS data was compiled from various sources. While deemed reliable, the Planning Office assumes no liability.
3/11/2015 9:56:03 AM Y:\Projects\Urban Islands\Urban Islands 2015\UrbanIslands2015_master.mxd

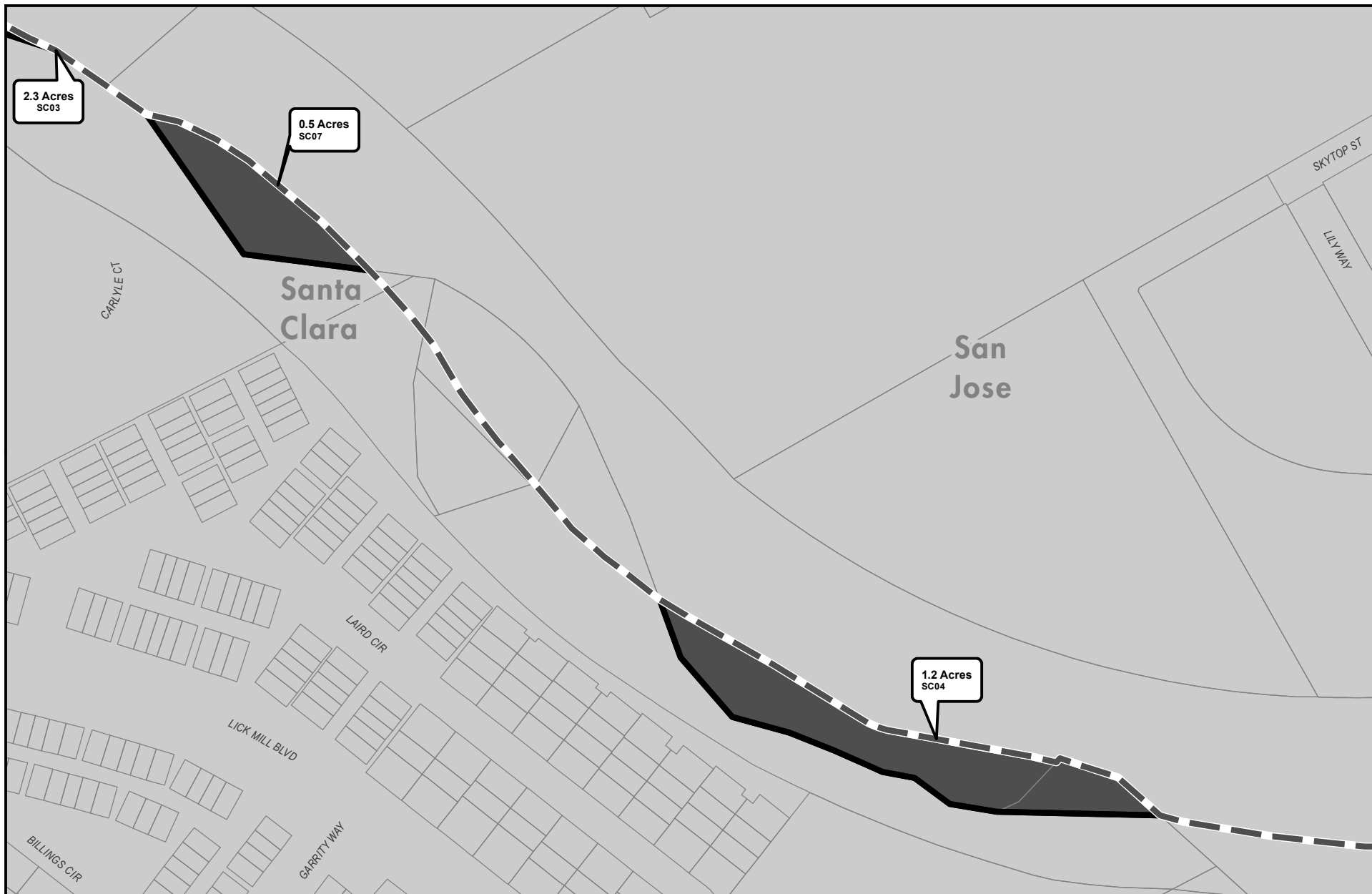

SANTA CLARA COUNTY Urban Islands 2015

Maps depicting unincorporated lands located within the cities' Urban Service Areas (USAs)

Santa Clara: Page 3 of 5

 Incorporated Areas

 Urban Service Area

 Urban Island ≤ 150 Acres

 Urban Island > 150 Acres

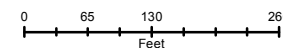

This map created by the Santa Clara County Planning Office. The GIS data was compiled from various sources. While deemed reliable, the Planning Office assumes no liability.
3/11/2015 9:56:03 AM Y:\Projects\Urban Islands\Urban Islands 2015\UrbanIslands2015_master.mxd

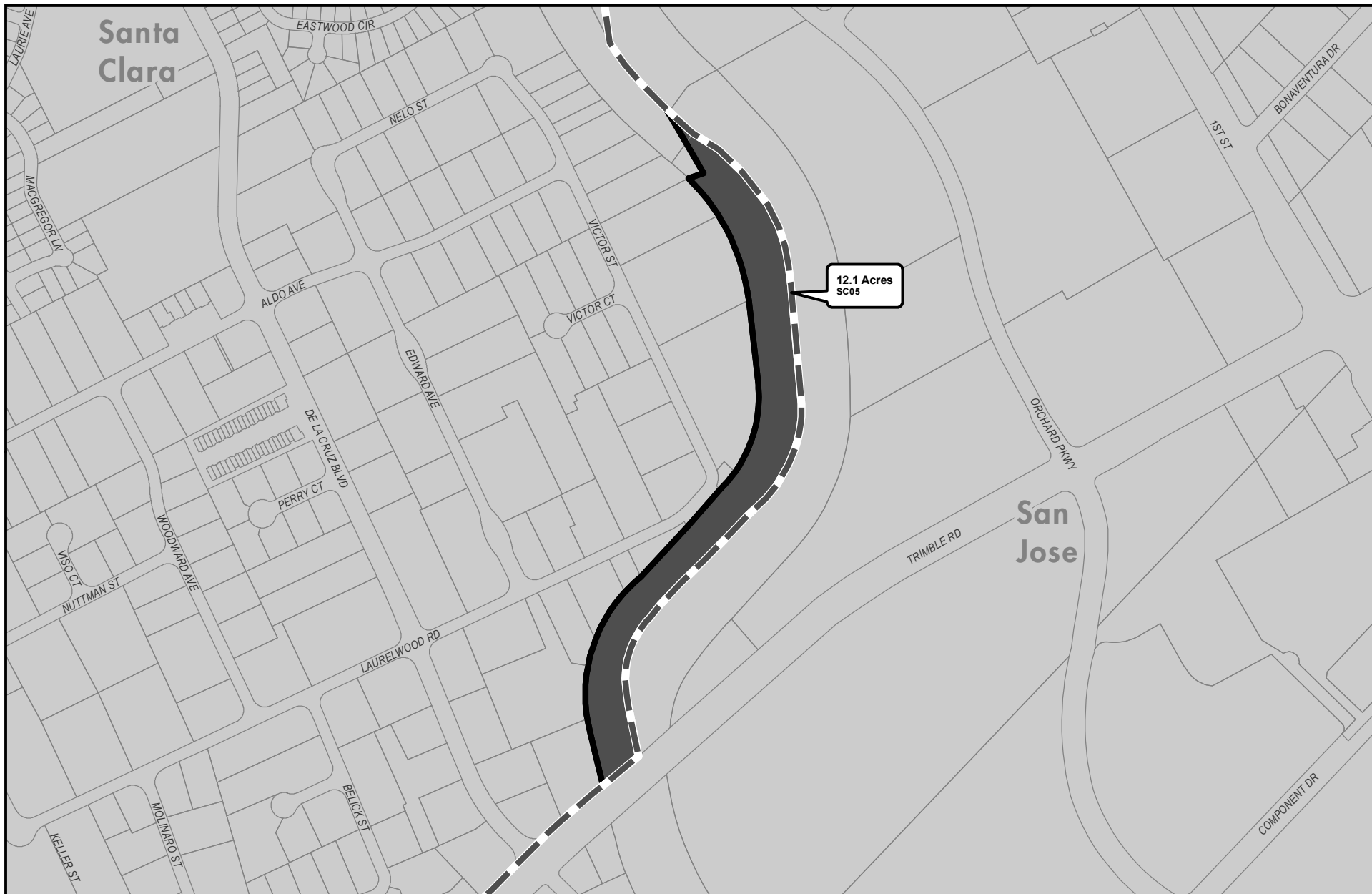

SANTA CLARA COUNTY Urban Islands 2015

Maps depicting unincorporated lands located within the cities' Urban Service Areas (USAs)

Santa Clara: Page 4 of 5



Incorporated Areas



Urban Service Area



Urban Island \leq 150 Acres



Urban Island $>$ 150 Acres

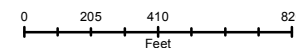

This map created by the Santa Clara County Planning Office. The GIS data was compiled from various sources. While deemed reliable, the Planning Office assumes no liability.
3/11/2015 9:56:03 AM V:\Projects\Urban Islands\Urban Islands 2015\UrbanIslands2015_master.mxd



SANTA CLARA COUNTY Urban Islands 2015

Maps depicting unincorporated lands located within the cities' Urban Service Areas (USAs)

Santa Clara: Page 5 of 5



Incorporated Areas



Urban Service Area



Urban Island ≤ 150 Acres



Urban Island > 150 Acres

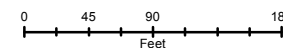

This map created by the Santa Clara County Planning Office. The GIS data was compiled from various sources. While deemed reliable, the Planning Office assumes no liability. 3/11/2015 9:56:03 AM \\P\Projects\Urban Islands\Urban Islands 2015\UrbanIslands2015_master.mxd

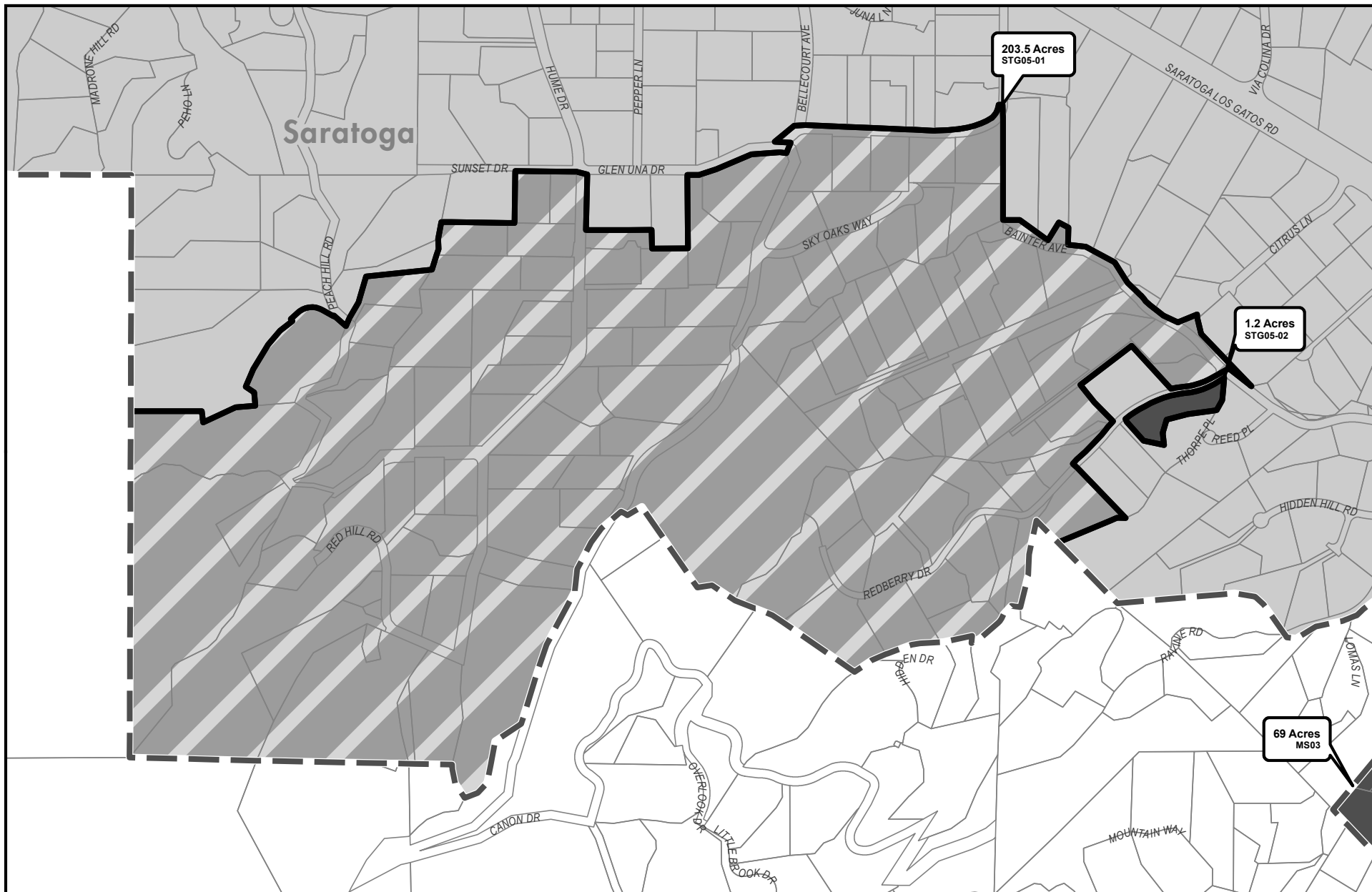

SANTA CLARA COUNTY Urban Islands 2015

Maps depicting unincorporated lands located within the cities' Urban Service Areas (USAs)

Saratoga: Page 1 of 1

 Incorporated Areas

 Urban Service Area

 Urban Island ≤ 150 Acres

 Urban Island > 150 Acres

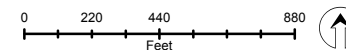

This map created by the Santa Clara County Planning Office. The GIS data was compiled from various sources. While deemed reliable, the Planning Office assumes no liability.
3/11/2015 11:00:07 AM Y:\Projects\Urban Islands\Urban Islands 2015\UrbanIslands2015_master.mxd

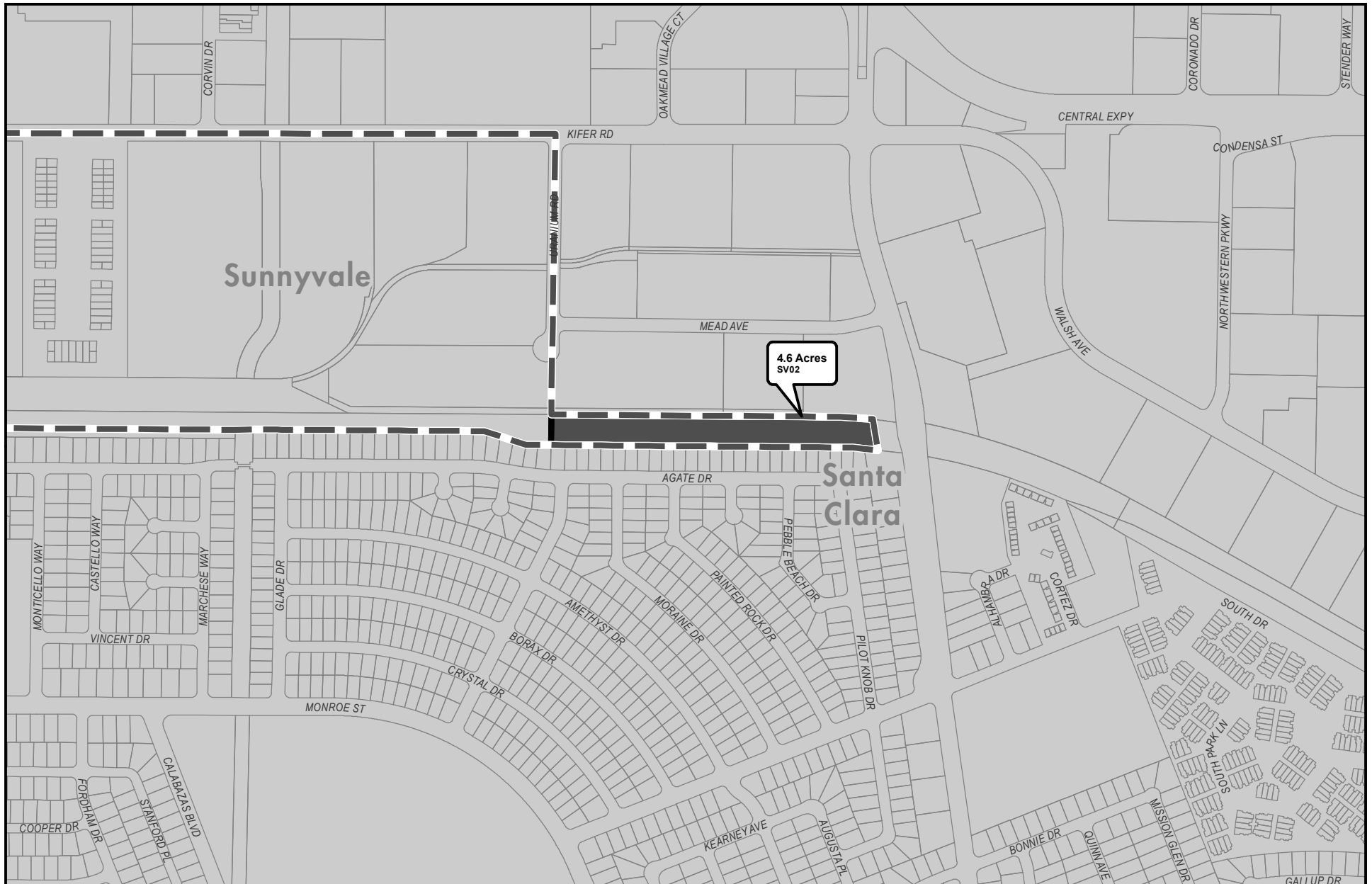

SANTA CLARA COUNTY Urban Islands 2015

Maps depicting unincorporated lands located within the cities' Urban Service Areas (USAs)

Sunnyvale: Page 1 of 2

 Incorporated Areas

 Urban Service Area

 Urban Island ≤ 150 Acres

 Urban Island > 150 Acres

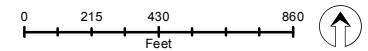

This map created by the Santa Clara County Planning Office. The GIS data was compiled from various sources. While deemed reliable, the Planning Office assumes no liability.
3/11/2015 9:56:03 AM Y:\Projects\Urban Islands\Urban Islands 2015\UrbanIslands2015_master.mxd



SANTA CLARA COUNTY Urban Islands 2015

Maps depicting unincorporated lands located within the cities' Urban Service Areas (USAs)

Sunnyvale: Page 2 of 2



Incorporated Areas



Urban Service Area



Urban Island ≤ 150 Acres



Urban Island > 150 Acres

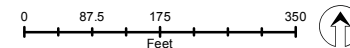

This map created by the Santa Clara County Planning Office. The GIS data was compiled from various sources. While deemed reliable, the Planning Office assumes no liability. 3/11/2015 9:56:03 AM \\P:\Projects\Urban Islands\Urban Islands 2015\UrbanIslands2015_master.mxd